

# Dimensions

## Type DT/DV Motors and Brakemotors - Foot Mounted

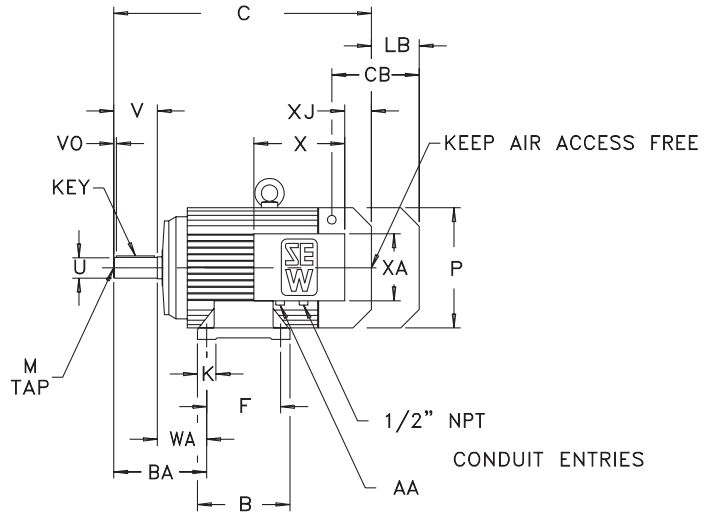
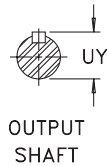
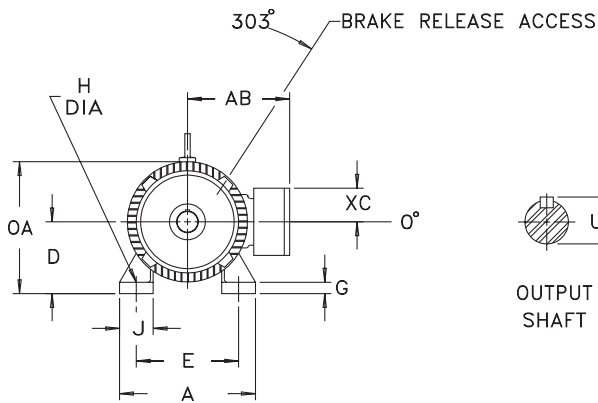

### Motor

Model	A	B	BA	C	CB	D	E	F	G	H	J	K	LB	OA	P	WA
DV132S	9.84	6.69	6.65	18.66	3.82	5.20 <sup>+0</sup> <sub>-.02</sub>	8.50	5.51	0.83	0.47	2.44	1.38	3.15	9.57	8.70	3.50
	250	170	169	474	97	132 <sup>+0</sup> <sub>-.5</sub>	216	140	21	12	62	35	80	243	221	89
DV132M	10.20	8.58	6.65	18.98	4.41	5.20 <sup>+0</sup> <sub>-.02</sub>	8.50	7.01	0.67	0.51	2.60	1.77	4.41	10.63	10.83 <sup>1)</sup>	3.50
	259	218	169	482	112	132 <sup>+0</sup> <sub>-.5</sub>	216	178	17	13	66	45	112	270	275 <sup>1)</sup>	89
DV132ML <sup>2)</sup>	11.38	9.92	7.40	21.34	4.41	6.30 <sup>+0</sup> <sub>-.02</sub>	10.00	8.27	0.98	0.59	3.23	1.97	4.41	11.73	10.83	4.25
	289	252	188	542	112	160 <sup>+0</sup> <sub>-.5</sub>	254	210	25	15	82	50	112	298	275	108
DV160M	11.38	9.92	8.58	22.52	4.41	6.30 <sup>+0</sup> <sub>-.02</sub>	10.00	8.27	0.98	0.59	3.23	1.97	4.41	11.73	10.83	4.25
	289	252	218	572	112	160 <sup>+0</sup> <sub>-.5</sub>	254	210	25	15	82	50	112	298	275	108
DV160L	12.13	11.57	8.58	24.13	6.30	6.30 <sup>+0</sup> <sub>-.02</sub>	10.00	10.00	0.75	0.55	2.95	2.56	6.14	12.83	13.03 <sup>1)</sup>	4.25
	308	294	218	613	160	160 <sup>+0</sup> <sub>-.5</sub>	254	254	19	14	75	65	156	326	331 <sup>1)</sup>	108

### Output Shaft

Model	U	UY	V	VO	Key	M
DV132S	1.496 <sup>+0.0007</sup> <sub>+0.0001</sub>	1.61	3.15	0.20	.39 x .31 x 2.76	M12 x 1.10
	38 <sup>+0.018</sup> <sub>+0.002</sub>	41	80	5	10 x 8 x 70	M12 x 28
DV132M	1.496 <sup>+0.0007</sup> <sub>+0.0001</sub>	1.61	3.15	0.20	.39 x .31 x 2.76	M12 x 1.10
	38 <sup>+0.018</sup> <sub>+0.002</sub>	41	80	5	10 x 8 x 70	M12 x 28
DV132ML	1.496 <sup>+0.0007</sup> <sub>+0.0001</sub>	1.61	3.15	0.20	.39 x .31 x 2.76	M12 x 1.10
	38 <sup>+0.018</sup> <sub>+0.002</sub>	41	80	5	10 x 8 x 70	M12 x 28
DV160M	1.654 <sup>+0.0007</sup> <sub>+0.0001</sub>	1.77	4.33	0.39	.47 x .31 x 2.76	M16 x 1.42
	42 <sup>+0.018</sup> <sub>+0.002</sub>	45	110	10	12 x 8 x 70	M16 x 36
DV160L	1.654 <sup>+0.0007</sup> <sub>+0.0001</sub>	1.77	4.33	0.39	.47 x .31 x 2.76	M16 x 1.42
	42 <sup>+0.018</sup> <sub>+0.002</sub>	45	110	10	12 x 8 x 70	M16 x 36

### Conduit Box

	AA	AB	X	XA	XC	XJ
<sup>3</sup> / <sub>4</sub> NPT	7.40	6.57	4.84	2.40	1.85	
—	188	167	123	61	47	
<sup>1</sup> / <sub>4</sub> NPT	9.13	7.52	6.34	3.15	2.17	
—	232	191	161	80	55	
<sup>1</sup> / <sub>4</sub> NPT	9.13	7.52	6.34	3.15	2.17	
—	232	191	161	80	55	
<sup>1</sup> / <sub>4</sub> NPT	9.13	7.52	6.34	3.15	2.32	
—	232	191	161	80	59	
2 x <sup>1</sup> / <sub>2</sub> NPT	10.04	8.86	9.06	3.66	5.98	
—	255	225	230	93	152	

<sup>1)</sup> Fan Guard flattened at base.  
<sup>2)</sup> "D" dimension is not per IEC.

Dimensions are  $\frac{\text{inch}}{\text{mm}}$   
 Dimension LB is for brake option.  
 Dimension CB is for brake release access.  
 Eye bolts are removable.

## Parts List

### AC squirrel-cage motors DFV112M-DFV132S To be mounted to gear units

08 660 47

① D34+D35 ② D35

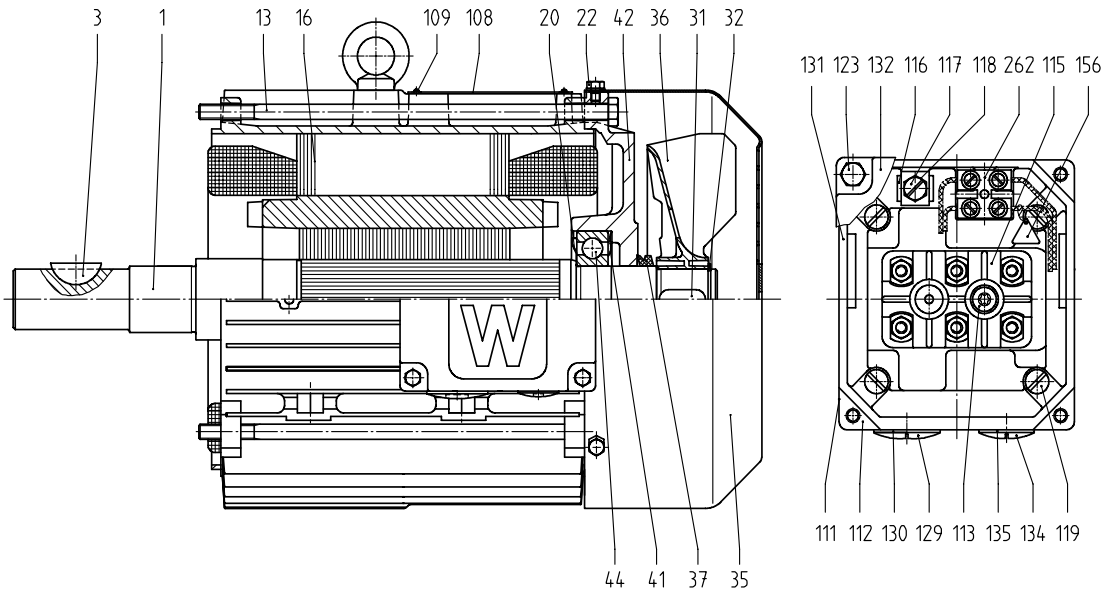

No.	Description	DIN standard label	Part No.	Qty	No.	Description	DIN standard label	Part No.	Qty
1	Rotor cpl. DFV112M-4 ①		0 181 151 7	1	108	Nameplate			1
1	Rotor cpl. DFV112M-6 ①		0 183 365 0	1	109	Round head pin	DIN1476 2x4-X5CrNi19.11	0 010 764 6	2
1	Rotor cpl. DFV132S-4 ②		0 181 158 4	1	111	Gasket f. p. 112		0 135 563 5	1
1	Rotor cpl. DFV132S-6 ②		0 183 373 1	1	112	Terminal box bottom		0 135 560 0	1
3	Woodruff key	DIN6888 8x11-ST60	0 010 859 6	1	113	Cheese head screw	DIN84 AM5x16Sp-4.8	0 012 962 3	1
13	Hexagon screw DFV112M	DIN931 M8x220-8.8-A1C	0 011 685 8	4	115	Terminal block	KTM5	0 011 760 9	1
13	Hexagon screw DFV132S	DIN931 M8x265-8.8-A1C	0 011 686 6	4	116	Terminal clamp	DIN46282 C10-Ms-vn	0 010 442 6	2
16	Stator compl.			1	117	Hexagon head cap screw	DIN933 M5x12Sz-CU3-E2E	0 011 217 8	1
20	Nilos ring	6207-ZAV	0 011 795 1	1	118	Lock washer	DIN7980 5-vn	0 011 820 6	1
22	Hexagon head cap screw	DIN933 M5x7Z1-8.8-A2C	0 013 630 1	4	119	Cheese head screw	DIN84 AM5x16Sp-4.8	0 012 962 3	4
24	Lifting eyebolt	DIN580 M8	0 011 304 2	1	123	Hexagon head cap screw	DIN933 M5x16Sp-8.8-A2C	0 012 291 2	4
31	Key	DIN6885 A10x8x25	0 011 619 X	1	129	Screw plug	DIN46320 NPg21-FS	0 010 832 4	1
32	Circlip/snap ring	DIN471 32x1,5	0 010 278 4	1	130	Sealing ring	DIN7603 A28x33-Gi	0 011 913 X	1
35	Fan guard		0 182 450 3	1	131	Gasket f. p. 132		0 135 562 7	1
36	Fan		0 182 324 8	1	132	Terminal box cover		0 135 558 9	1
37	V-ring	V-35	0 011 479 0	1	134	Screw plug	DIN46320 NPg11-FS	0 010 828 6	1
41	Equalizing ring	61x71x0,4 K3	0 011 584 3	1	135	Sealing ring	DIN7603 A18x22-Gi	0 011 911 3	1
42	B side brg. end shield		0 135 334 9	1	153	Connect. terminal cpl. a)		0 182 333 7	1
44	Deep groove ball bearing	DIN625 6207-J	0 011 718 8	1	156	Label plate a)		0 136 681 5	1

a)Parts for TF version

When ordering spare parts always quote nameplate data with serial number and designation with part number!

# Parts List

08 651 08 87



AC motor

DV/DVE 112M-132S

Foot mounting

EN Page 1 / 2

EM 12.02.2007

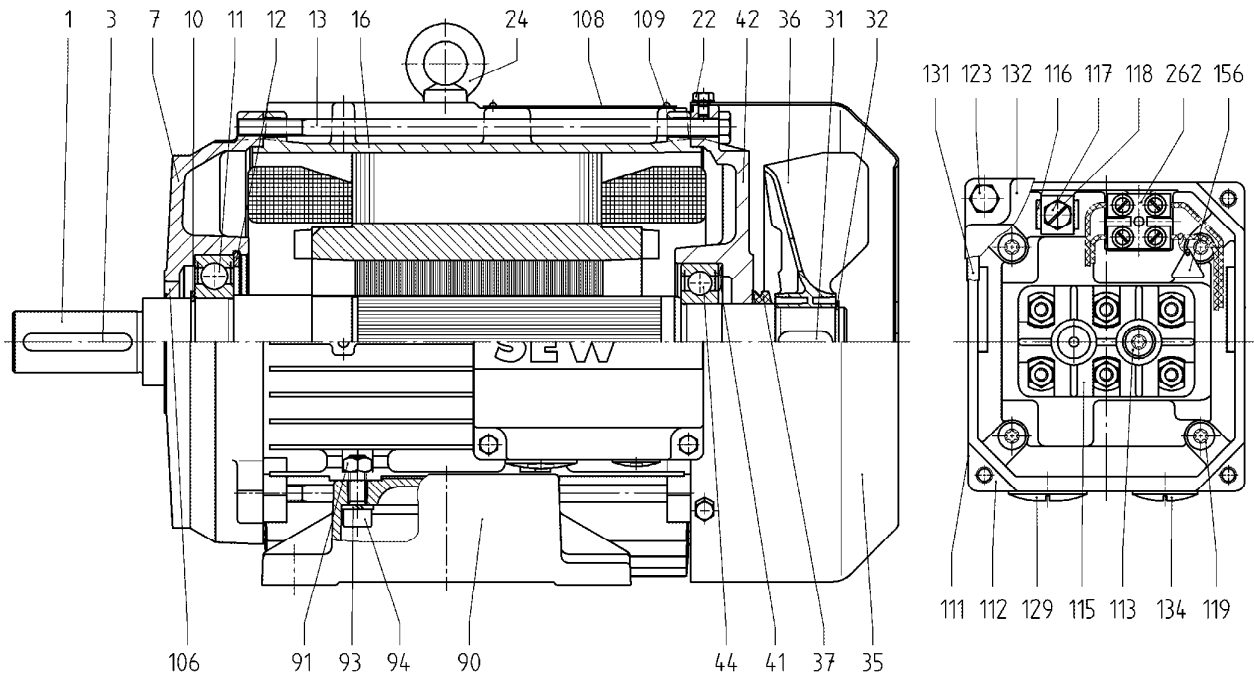

No.	Description	Additional specifications	SEW standard label	Part No.	Qty.
1	Rotor	IEC 28x60	DV112M4	01353829	1
1	Rotor	IEC 28x60	DV112M8	01833634	1
1	Rotor	IEC 28x60	DV112M12/2	01353837	1
1	Rotor	IEC 28x60	DVE112M4	01875515	1
1	Rotor	IEC 38x80	DV132S4	01357409	1
1	Rotor	IEC 38x80	DV132S8	01833693	1
1	Rotor	IEC 38x80	DV132S12/2	01357417	1
1	Rotor	IEC 38x80	DVE132S4	01875523	1
3	Key	for IEC 28x60	DIN6885-1 A8x7x50 +C	00100234	1
3	Key	for IEC 38x80	DIN6885-1 A10x8x70 +C	00100307	1
7	A bearing end shield			01366947	1
10	Circlip		DIN471 40x1,75	00102830	1
11	Deep groove ball bearing		6208-2Z-J-K2P-20	00159891	1
12	Circlip		DIN472 80x2,5	00103241	1
13	Hex head screw	DV112M	ISO4014 M8x220-8.8-ADB3	00116858	4
13	Hex head screw	DVE112M/DV132S	ISO4014 M8x265-8.8-ADB3	00116866	4
13	Hex head screw	DVE132S	ISO4014 M8x305-8.8-A2F	13223577	4
16	Stator			*	1
22	Hex head screw		DIN933 M5x7 Z1-8.8-A2F	00136301	4
24	Lifting eye bolt		DIN580 M8	00113042	1
31	Key		DIN6885 A10x8x25-C45K	0011619X	1
32	Circlip		DIN471 32x1,5	00102784	1
35	Fan Guard			01824503	1
36	Fan			01823248	1
37	V-seal		W4278 V-35S-NBR	00114790	1
41	Equalizing ring		W4253 61x71x0,6	00115916	1

\* order-dependently

When ordering spare parts always quote nameplate data with serial number and designation with part number!

Copyright reserved! All rights reserved according to DIN ISO 16016.

SEW-EURODRIVE GmbH & Co KG Postfach 3023, D-76642 Bruchsal Tel. (07251) 75-0. Fax (07251) 75-1970. <http://www.sew.de>

# Parts List

08 651 08 87



AC motor

DV/DVE 112M-132S

Foot mounting

EN Page 2 / 2

EM 12.02.2007

No.	Description	Additional specifications	SEW standard label	Part No.	Qty.
42	B bearing end shield			01353349	1
44	Deep groove ball bearing		DIN625 6207-2Z-J-K2P-20	00174181	1
90	Foot	DV/DVE112M; parts included in stator complete		01800620	2
90	Foot	DV/DVE132S; parts included in stator complete		01800639	2
91	Hex nut	parts included in stator complete	ISO4032 M8-8	00101990	4
93	Lock washer	parts included in stator complete	DIN128 A8-FST-PHR	00109916	4
94	Machine screw	parts included in stator complete	ISO4762 M8x25-8.8	00110345	4
106	Oil seal without spring		DIN3760 A40x55x7-NBR	0011197X	1
106	Oil seal	for 2-pole version	DIN3760 A40x55x7-FKM	00159786	1
108	Nameplate			*	1
109	Grooved Pin		ISO8746 2x4-X5CRNI18-12	00107646	2
111	Gasket for lower part			01355635	1
112	Terminal box lower part		1x M32x1,5 / 1x M16x1,5	01862839	1
113	Pan head screw	parts included in stator complete	W4046 M5x16-Tx-ST-A2F-GM	00135720	1
115	Terminal Block	parts included in stator complete	W4723 KTM5	00117609	1
116	Terminal clip		DIN46282 C10-MS-VN	00104426	2
117	Hex head screw		ISO4017 M5x12SZ-CU3-E2E	00112178	1
118	Lock washer		DIN7980 5-FST-VN	00118206	1
119	Pan head screw		W4046 M5X16-TX-SZ-ST-A2F-GM	00130591	4
123	Hex head screw		ISO4017 M5x16SP-8.8-A2F	00122912	4
129	Screw Plug with O-Ring		W4411 M32x1,5-FS-NBR-OZ	00131393	1
131	Gasket for cover			01355627	1
132	Terminal Box Cover			01355589	1
134	Screw Plug with O-Ring		W4411 M16x1,5-FS-NBR-OZ	00131334	1
156	Reference Plate	for TF version	W4499 - TF	01366815	1
262	Terminal clip complete	for TF version		01823337	1

\* order-dependently

When ordering spare parts always quote nameplate data with serial number and designation with part number!

Copyright reserved! All rights reserved according to DIN ISO 16016.

SEW-EURODRIVE GmbH & Co KG Postfach 3023. D-76642 Bruchsal Tel. (07251) 75-0. Fax (07251) 75-1970. <http://www.sew.de>



# Parallel Helical Reducer R/RF132/133A

**PARTS LIST**

**01 339 784 US**

- ① R132/133A with 3.625 in. Dia. Shaft
- ② RF132/133A with 3.625 in. Dia. Shaft

- ③ R132/133A with 90mm Dia. Shaft
- ④ RF132/133A with 90mm Dia. Shaft

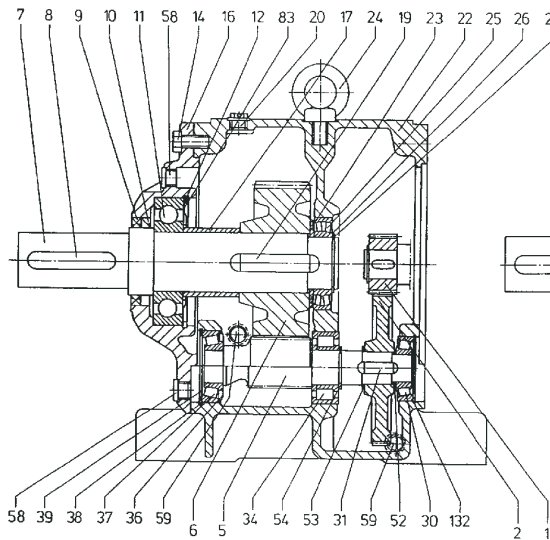

2-gear stages

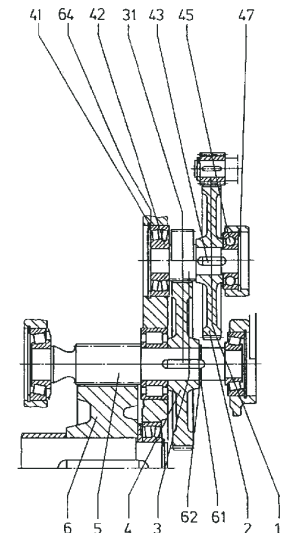
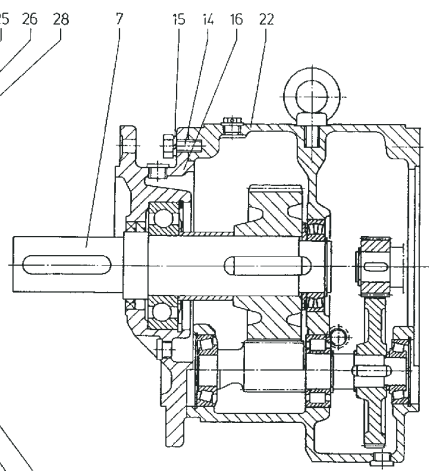

3-gear stages

When ordering parts, please supply nameplate data with serial number or S.O. number, model number, description of part and part number. All gears are stamped with a part number.

X - As required  
Shaded items denote recommended spare parts.  
Ⓢ - Sealant for all flanged sealing surfaces.

Item	Part Name	Description	Part No	Qty
1	Pinion			1
2	Gear			1
3	Pinion Shaft			1
4	Gear			1
5	Pinion			1
6	Gear			1
7	Output Shaft	①② 3.625 in. Dia.	116 134 2	1
7	Output Shaft	③④ 90mm Dia.	116 133 4	1
8	Key	①② 7/8x7/8x4-5/8 in.	806 929 8	1
8	Key	③④ A25x14x140mm	010 048 X	1
9	Oil Seal	AS105x140x12mm	010 671 2	1
10	Oil Seal	A105x140x12mm	010 643 7	1
11	Ball Bearing	6319	011 060 4	1
12	Retaining Ring	200x4mm Internal	011 458 8	1
14	Hex Head Screw	①③ M16x40mm	010 127 3	8
14	Hex Head Screw	550mm Fl.②④ M16x40mm	010 127 3	8
14	Hex Head Screw	450mm Fl.②④ M16x45mm	011 024 8	8
15	Lockwasher	②④ B16mm	010 995 9	8
16	Output Cover	①③	116 128 8	1
16	Output Flange	②④ 450mm Dia.	116 130 X	1
16	Output Flange	②④ 550mm Dia.	116 132 6	1
17	Spacer		116 135 0	1
19	Key	B28x16x90mm	013 481 3	1
20	Breather Plug	M22x1.5mm	013 032 X	1
22	Gearcase	①③	116 469 4	1
22	Gearcase	②④	116 471 6	1
23	Spacer		116 211 X	1
24	Eyebolt	M24mm	010 233 4	1
25	Roller Bearing	22215E	010 590 2	1

Item	Part Name	Description	Part No	Qty
26	Shim	75x90x0.1mm	012 054 5	X
26	Shim	75x90x0.3mm	012 055 3	X
28	Retaining Ring	75x4mm External	010 310 1	1
30	Taper Roller Bearing	30308	010 604 6	1
31	Key-Hardened	2 Stage B14x9x40mm	010 060 9	1
31	Key-Hardened	3 Stage B16x10x40mm	011 005 1	1
34	Roller Bearing	NUP2310E	013 707 3	1
36	Nilos Ring	30310AV	013 653 0	1
37	Taper Roller Bearing	30310	012 469 9	1
38	Shim	90x110x0.1mm	010 382 9	X
38	Shim	90x110x0.3mm	010 406 X	X
39	Retaining Ring	110x4mm Internal	010 328 4	1
41	Retaining Ring	110x4mm Internal	010 328 4	1
42	Roller Bearing	22308	010 593 7	1
43	Key-Hardened	B12x8x28mm	011 487 1	1
45	Ball Bearing	6407	010 540 6	1
47	Retaining Ring	100x3mm Internal	010 327 6	1
52	Thrust Washer	S40x50x2.5mm	010 352 7	1
53	Thrust Washer	S45x55x3mm	010 353 5	1
54	Retaining Ring	50x2mm External	010 289 X	1
58	Drain Plug	M22x1.5mm	011 431 6	2
59	Drain Plug	M22x1.5mm	011 431 6	3
61	Retaining Ring	3 Stage 50x2mm External	010 289 X	1
62	Shim	3 Stage 50x62x0.1mm	010 376 4	X
62	Shim	3 Stage 50x62x0.3mm	010 400 0	X
64	Shim	70x90x0.1mm	010 380 2	X
64	Shim	70x90x0.3mm	010 404 3	X
83	Nilos Ring	6319JV	011 819 2	1
132	Retaining Ring	90x3mm Internal	010 326 8	1
999	Anaerobic Sealant	Ⓢ Tube	910 255 8	X

# Technical Note

## AD..Input Shaft Assembly Dimension Comparisons

Mechanical

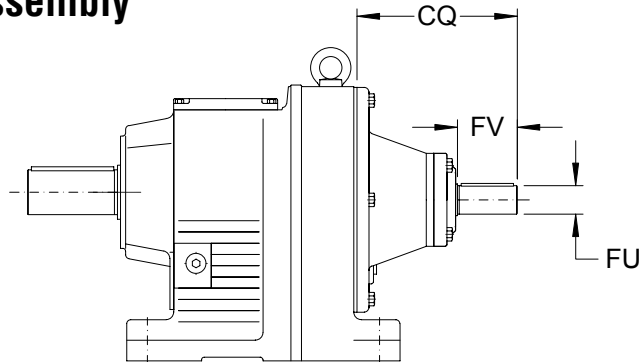

Gear Unit	Input Size FU x FV (in)	CQ Dimension (inches)									
		OLD	AD1	AD2	AD3	AD3	AD4	AD5	AD6	AD7	AD8
			.625 x 1.575	.75 x 1.575	.875 x 1.97	1.125 x 2.36	1.375 x 3.15	1.625 x 4.33	1.875 x 4.33	2.125 x 4.33	2.75 x 5.51
R..27/37 F..37/47 K..37 S..37/47/57		4.53	4.02	5.12							
R..47/57/67 F..57/67 K..47/57/67 S..67		4.72		4.84	6.26						
R..77 F..77 K..77 S..77		5.51		4.57	5.95		8.82				
R..87 F..87 K..87 S..87		7.09		4.37		6.14	8.62	11.50			
R..97 F..97 K..97 S..97		8.61				5.95	8.43	11.30	12.87		
R..107 F..107 K..107		10.63				5.71	8.19	11.06	12.64		
R..137		12.09					7.91	10.79	12.36	12.13	
R..147 F..127 K..127		11.69					7.60	10.47	12.05	11.81	15.08
R..167 F..157 K..157/167		14.72						10.13	11.73	11.50	14.72

□ Indicates the new AD Input Size that has the same shaft dimensions (FU x FV) as the old Input Assembly.

# Technical Note

## R Series – Helical Units

Dimension Comparisons – Flange Mounted

Old		New
RF80/82/83	⇒	RF87
RF92/93	⇒	RF97
RF102/103	⇒	RF107
RF132/133	⇒	RF137
RF142/143	⇒	RF147
RF152/162	⇒	RF167

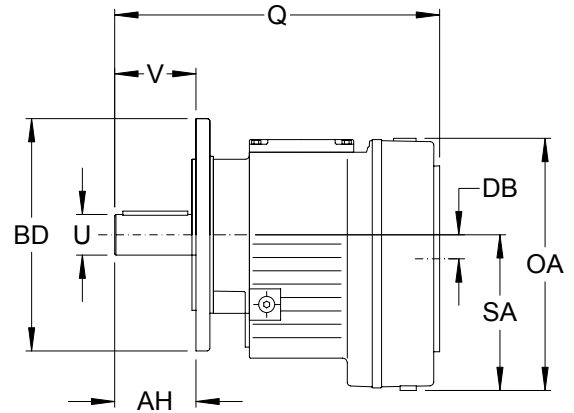
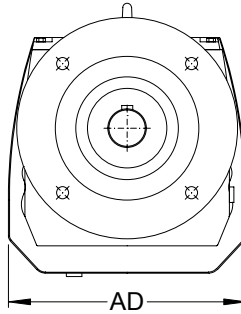

Dimensions are millimeters, unless otherwise indicated.

Size	AD	DB	OA	Q	SA	*AH	BD	U in mm	V
<b>RF87</b>	<b>297</b>	<b>12.6</b>	<b>299</b>	<b>372</b>	<b>184</b>	<b>100</b>	<b>350/300</b>	<b>2.125"</b> <b>50</b>	<b>100</b>
RF80	285	-	318	395	184	160	350	2.125"	100
RF82/83	290	-	320	395	183	160	350	2.125"	100
						110	300	50	
<b>RF97</b>	<b>348</b>	<b>10.2</b>	<b>374</b>	<b>440</b>	<b>230</b>	<b>120</b>	<b>450/350</b>	<b>2.375"</b> <b>60</b>	<b>120</b>
RF92/93	340	-	386	462	225	190	450	2.375"	120
						130	350	60	
<b>RF107</b>	<b>409</b>	<b>20.4</b>	<b>413</b>	<b>495</b>	<b>255</b>	<b>140</b>	<b>450/350</b>	<b>2.875"</b> <b>70</b>	<b>140</b>
RF102/103	400	-	431	512	244	195	450	2.875"	140
						135	350	70	
<b>RF137</b>	<b>458</b>	<b>25.1</b>	<b>500</b>	<b>589</b>	<b>320</b>	<b>170</b>	<b>550/450</b>	<b>3.625"</b> <b>90</b>	<b>170</b>
RF132/133	450	-	481	601	264	220	550	3.625"	170
						170	450	90	
<b>RF147</b>	<b>540</b>	<b>33.4</b>	<b>571</b>	<b>695</b>	<b>361</b>	<b>210</b>	<b>550/450</b>	<b>4.375"</b> <b>110</b>	<b>210</b>
RF142/143	500	-	547	725	299	260	550	4.000"	210
						210	450	100	
<b>RF167</b>	<b>670</b>	<b>59.9</b>	<b>680</b>	<b>790</b>	<b>430</b>	<b>210</b>	<b>660/550</b>	<b>4.750"</b> <b>120</b>	<b>170</b>
RF152	600	-	671	745	375	275	660	4.750"	210
						210	550	120	
RF163	600	-	671	802	375	275	660	4.750"	210
						210	550	120	

Indicates dimensional change.

\* An optional shaft is available to match the AH dimension of the Figure I flange of the old series.