

Hoppman Centrifugal Feeder

- ▶ Model FR 30
- ▶ Serial 3556
- ▶ Machine Date Code: 12/86
- ▶ Drive: 1/8 HP 115V 43 RPM
- ▶ Inner Level: 28-1/2 in Diameter x 4 in H
- ▶ Upper Lane: 5-1/4 in W x 4-1/2 in H

Overall Dimensions

48 in L x 48 in W x 42 in H

Product Overview

Hoppmann's FR-30 feeds and orients a wide variety of parts utilizing the part's natural weight bias and loading ramp. The delivery rate varies from moderate to high speed depending on part characteristics. The FR-30 is designed to interface with Hoppmann prefeeders, accumulating conveyors, assembly systems and other downstream equipment.

Product Specifications

	U.S.	Global
A. Outer Wall Diameter	40.25"	1022mm
B. Overall Height	26.25"±1	667mm±25
C. Discharge Height	18.5"	470mm±25
D. Bowl Inner Diameter	28.8"	731mm
E. Rim Width	3.63"	92mm
Motor Size	1/8 HP	100 W
Motor Frame Size	NEMA 56C	IEC 71D
Supply Voltage	115 VAC	240 VAC
Motor Voltage	90 VDC	240 VAC 3PH
Power Usage	3 amps	3amps
Weight Untooled	350 lbs	159 kg

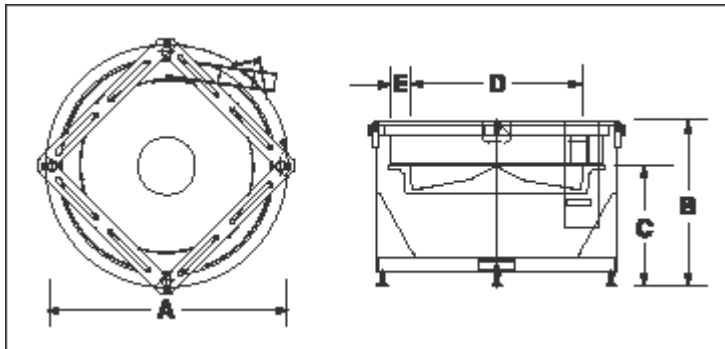

Standard Features

Durable cast urethane foam bowl , C-face motor/reducer,
Square tooling frame for quick changeover, Variable speed motor

Standard Options

Polycarbonate hinged top cover, Stainless steel construction,
Interchangeable tooling, AC controller, Flat ramps - wide /narrow, Air ramp







