

WCB Ice Cream Co. Ripple Pump

Mfg: WCB Ice Cream Co.

Model:

Stock No. HDWD188.5

Serial No.

WCB Ice Cream Co. Ripple Pump with 1 in. inlets, skid mounted. 5 gallon balance tank, Pump information is n/a with variable speed drive and 3/4 hp motor. 230/460 V. Overall dimensions 50 in. L x 21 in. W x 33 in. H.

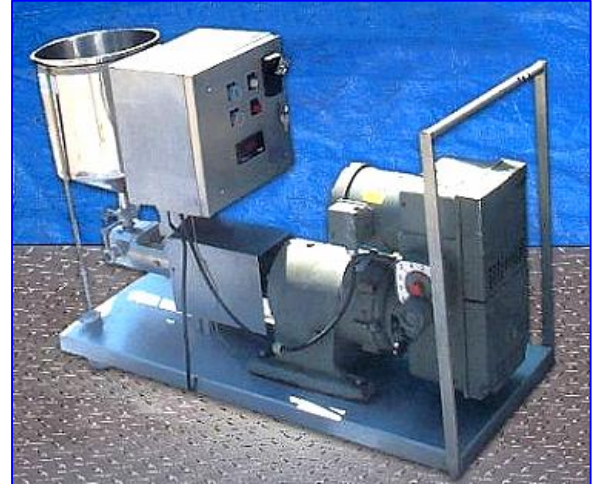

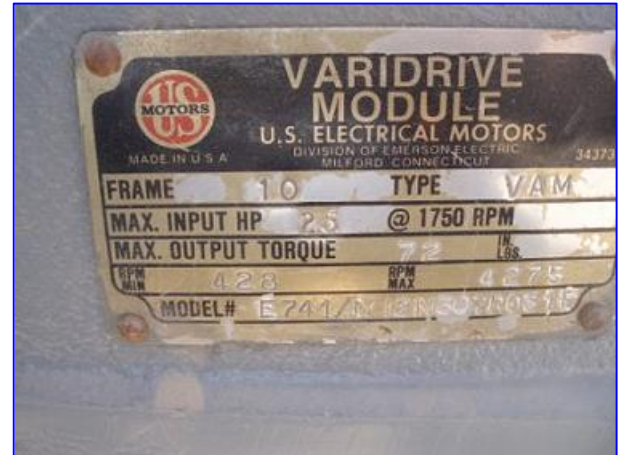
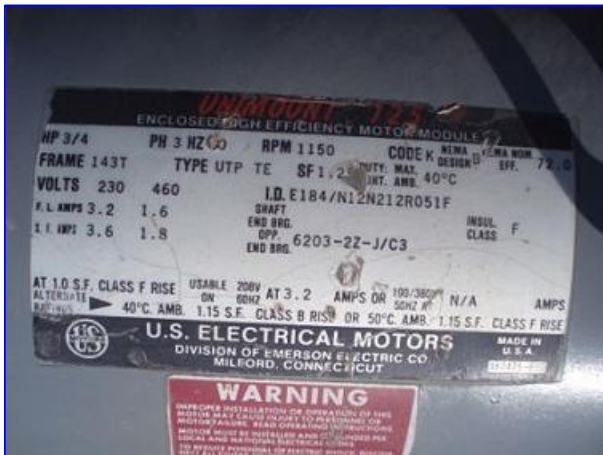
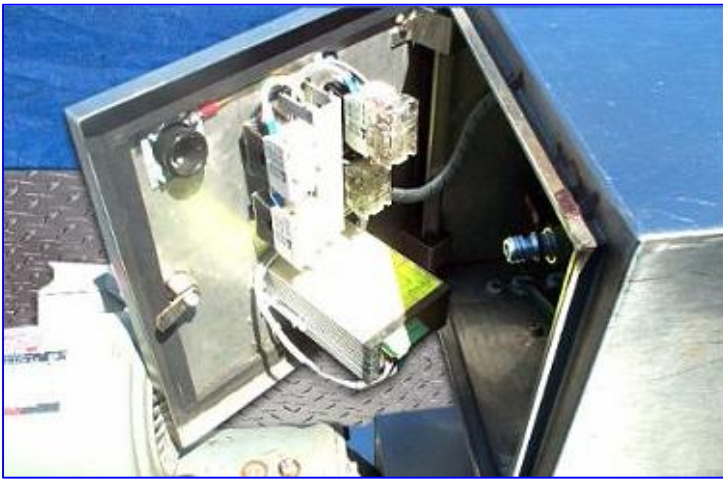

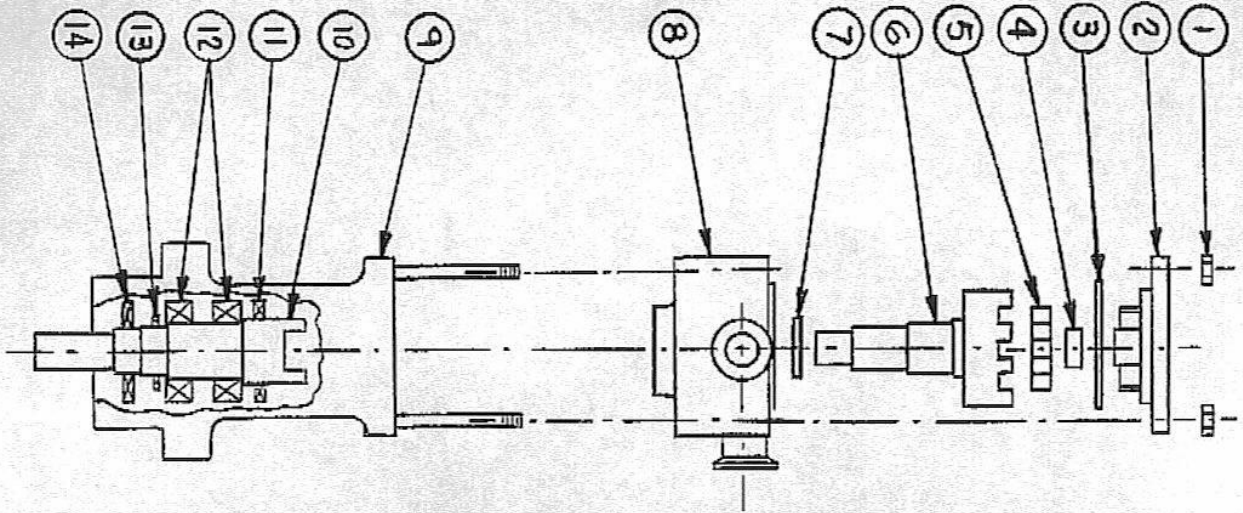

PARTS LIST		DESCRIPTION
ITEM	QTY	
1	4	NUT, 7/16" UC, PN-559
2	1	FACE PLATE, PN-137.008
3	1	O-RING, PN-598 OR 4337
4	1	BUSHING
5	1	IDLER GEAR, PN-172.002
6	1	ROTOR, PN-172.003
7	1	LIP SEAL, PN-596 -DI=125
8	1	BODY, PN-130.002
9	1	PUMP MOUNTING BRACKET, PN-110.001
10	1	PUMP DRIVE SHAFT, PN-1-05.002
11	1	PUMP SHAFT SEAL, PN-513-SM40627
12	2	PUMP SHAFT BEARINGS, PN-514-32007/X
13	2	PUMP SHAFT LOCK-NUT, PN-512-GUK 35
14	1	PUMP SHAFT SEAL, PN-511-SMIM3062/10

NOTES:
 1. PLEASE SPECIFY SIZE WHEN ORDERING BY DRAWING NO'S & ITEM NUMBER.
 2. PUMP SIZE - 3/8", 5/8" OR 7/8"

P.M.S.
 ICE CREAM EQUIPMENT SPECIALISTS
 RIPPLE PUMP

APPROVED BY _____
 DRAWN BY KM/GS SCALE NONE DATE 7 OCT 92 DRAWING # PA029392