

Back to LSC Outline
Drawings Menu

DO NOT SCALE
WORK TO DIMENSIONS SHOWN

REV.	ECN NO.	DATE	ZONE	CHANGES
0	711-0322	12/11/98		RELEASED-SUPERSEDES 2512OPEN.DWG
1	323-0697	1/11/01	4D	14 3/16 DIM WAS 13" FROM END OF IDR COVER (CHANGED POINT OF ORIGIN)

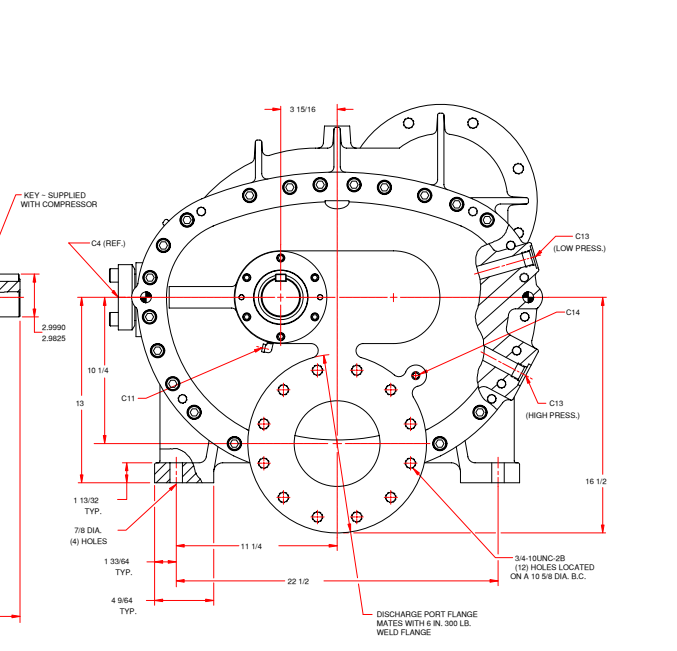
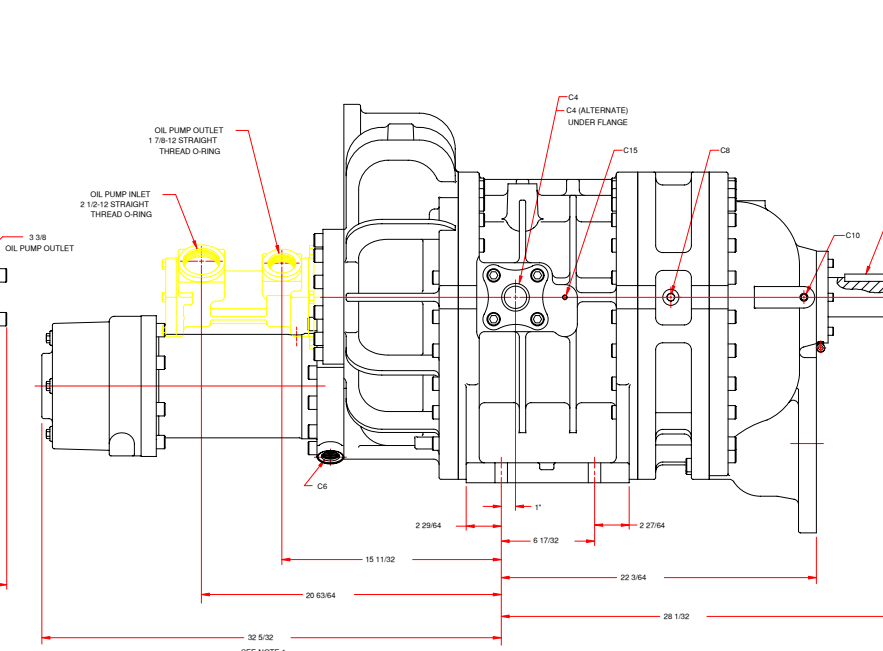
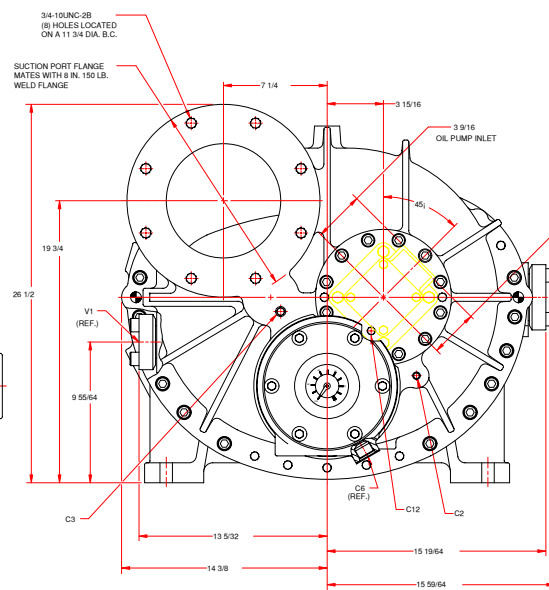
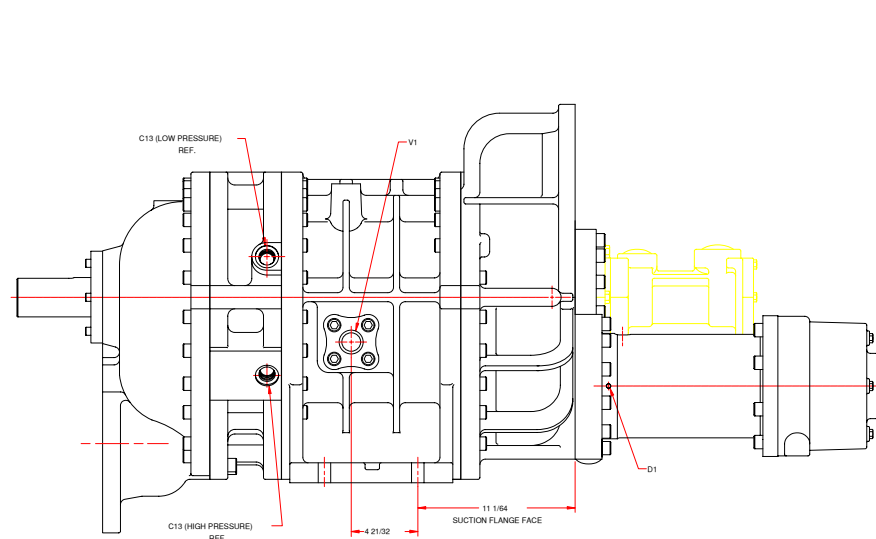
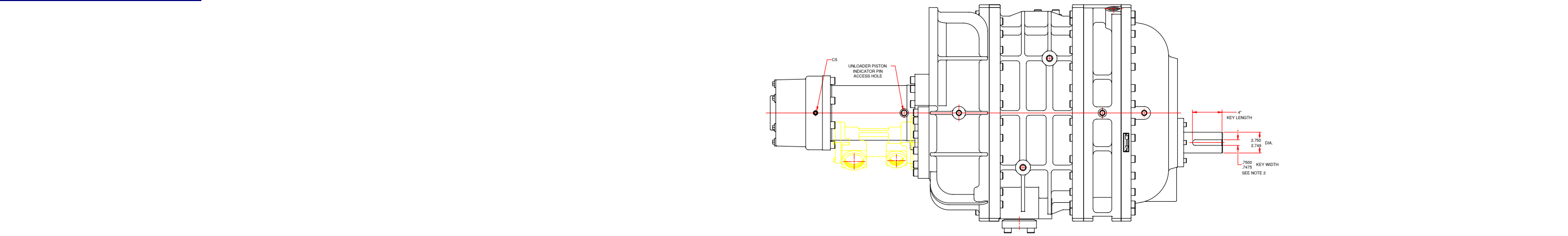

PORT	DESCRIPTION	PORT CONNECTION
C2	SUCTION BLEED OFF & SUCTION PRESSURE	1/4-18 NPTF (DRYSEAL)
C2 (ALTERNATE)	SUCTION BLEED OFF & SUCTION PRESSURE	3/8-18 NPTF (DRYSEAL)
C3	INLET BEARING OIL FEED	3/8-18 NPTF (DRYSEAL)
C4	COMPRESSOR MAIN OIL	WELD FLANGE FOR 1 1/2" PIPE
C4 (ALTERNATE)	COMPRESSOR MAIN OIL	1 5/8-12 STRAIGHT THREAD O-RING
C5	UNLOADER OIL	1/4-18 NPTF (DRYSEAL)
C6	OIL INJECTION	1 3/16-12 STRAIGHT THREAD O-RING
C8	SHAFT SEAL OIL SOURCE	3/8-18 NPTF (DRYSEAL)
C10	SHAFT SEAL OIL SUPPLY	1/4-18 NPTF (DRYSEAL)
C11	SHAFT SEAL WEEPAGE DRAIN	1/8-27 NPTF (DRYSEAL)
C12	UNLOADER OIL SUPPLY	3/8-18 NPTF (DRYSEAL)
C13 (LOW PRESS.)	LIQUID INJECTION	1 1/16-12 STRAIGHT THREAD O-RING
C13 (HIGH PRESS.)	LIQUID INJECTION	1 1/16-12 STRAIGHT THREAD O-RING
C14	DISCHARGE PRESSURE	1/4-18 NPTF (DRYSEAL)
C15	OIL PRESSURE	1/8-27 NPTF (DRYSEAL)
D1	LOADING OIL	1/8-27 NPTF (DRYSEAL)
D2	ATMOSPHERIC DRAIN	1/8-27 NPTF (DRYSEAL)
V1	VAPOR INJECTION	WELD FLANGE FOR 1 1/4" PIPE

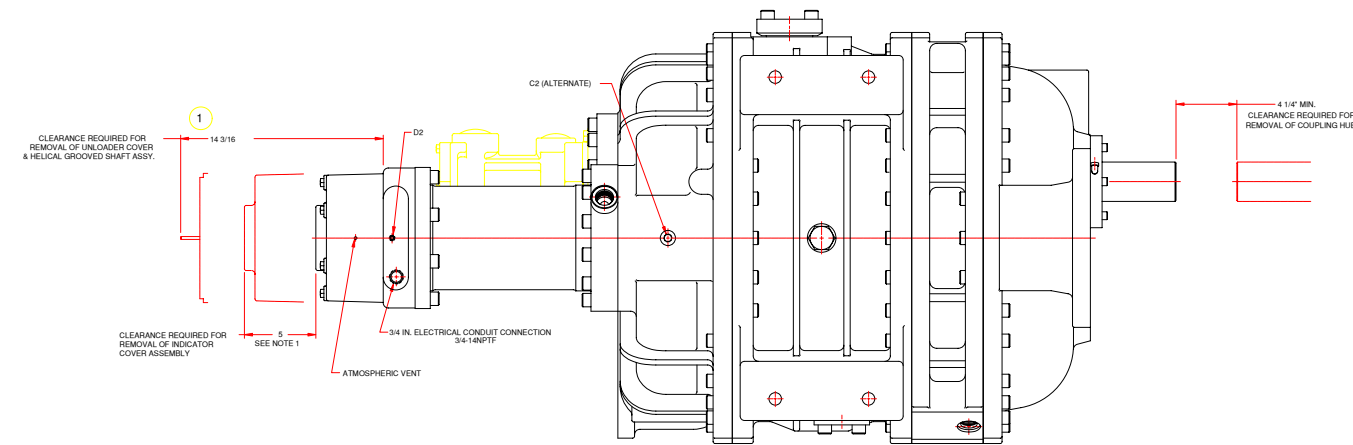

3. TO SHOW COMPRESSOR WITH OIL PUMP:
TURN OFF LAYER "NO_OIL_PUMP"
TURN ON LAYER "OIL_PUMP"
- TO SHOW COMPRESSOR WITHOUT OIL PUMP:
TURN OFF LAYER "OIL_PUMP"
TURN ON LAYER "NO_OIL_PUMP"
2. HARTFORD COMPRESSORS COUPLING PRACTICE:
HUB BORE = 2.7500 - 2.7495 DIA.
HUB KEYWAY = .750 - .748
SET SCREWS: (1) OVER KEYWAY & (1) 90° AWAY
1. DIMENSION TO END OF INDICATOR COVER APPLIES FOR COMPRESSORS WITH INDICATOR KITS PART NOS. 054258A3 & 054258A4. IF USING INDICATOR KIT PART NOS. 054258A1, 054258A2, 054258A5, 054258A6, 054258A7 OR 054258A8 THEN DIMENSION TO END OF INDICATOR COVER IS REDUCED BY 7/8 INCHES.

NOTES:
This drawing contains designs and other information which are the property of HARTFORD COMPRESSORS. This drawing may not be whole or in part, be duplicated or disclosed or used for manufacture of the part or closed herein, without prior written permission, from HARTFORD COMPRESSORS.

HARTFORD COMPRESSORS
Pioneers in Screw Compressor Technology
179 SOUTH STREET
WEST HARTFORD, CT 06110 U.S.A.

PART NAME: MODEL 2512 "F" VERSION DIMENSIONAL OUTLINE
MATL: OPEN MALE DRIVE

SCALE	DRAWN BY	REVIEWED	COMPRESSOR LINE
5/32	NAME T.BIANCO	NAME	LSC -255MM
DATE 12/11/98	DATE		

DRAWING NUMBER: **D5-056178J2** SHEET 1 OF 1 REV. 1

Back to LSC Outline
Drawings Menu

DO NOT SCALE
WORK TO DIMENSIONS SHOWN

REV.	ECN NO.	DATE	ZONE	CHANGES
0	711-0322	12/11/98		RELEASED-SUPERSEDES 2512CLOS.DWG
1	323-0697	1/11/01	4D	14 3/16 DIM WAS 13" FROM END OF IDR COVER (CHANGED POINT OF ORIGIN)

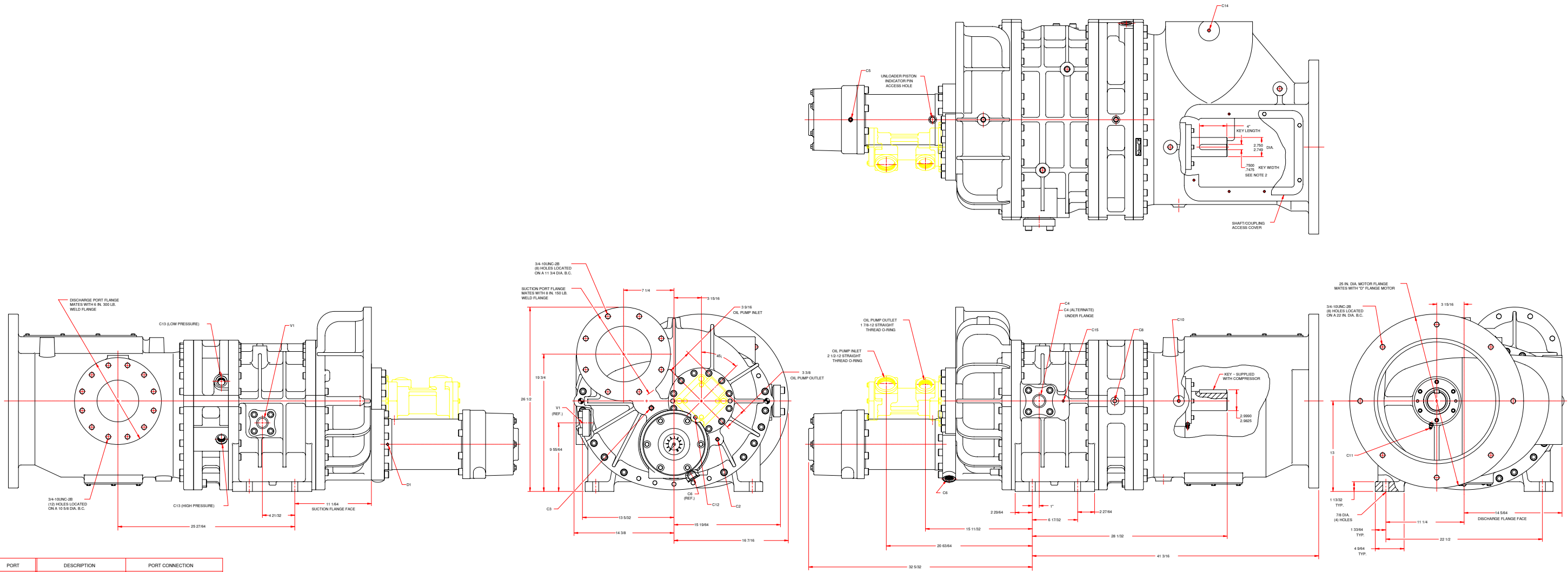

PORT	DESCRIPTION	PORT CONNECTION
C2	SUCTION BLEED OFF & SUCTION PRESSURE	1/4-18 NPTF (DRYSEAL)
C2 (ALTERNATE)	SUCTION BLEED OFF & SUCTION PRESSURE	3/8-18 NPTF (DRYSEAL)
C3	INLET BEARING OIL FEED	3/8-18 NPTF (DRYSEAL)
C4	COMPRESSOR MAIN OIL	WELD FLANGE FOR 1 1/2" PIPE
C4 (ALTERNATE)	COMPRESSOR MAIN OIL	1 5/8-12 STRAIGHT THREAD O-RING
C5	UNLOADER OIL	1/4-18 NPTF (DRYSEAL)
C6	OIL INJECTION	1 3/16-12 STRAIGHT THREAD O-RING
C8	SHAFT SEAL OIL SOURCE	3/8-18 NPTF (DRYSEAL)
C10	SHAFT SEAL OIL SUPPLY	1/4-18 NPTF (DRYSEAL)
C11	SHAFT SEAL WEEPAGE DRAIN	1/4" MALE FLARE
C12	UNLOADER OIL SUPPLY	3/8-18 NPTF (DRYSEAL)
C13 (LOW PRESS.)	LIQUID INJECTION	1 1/16-12 STRAIGHT THREAD O-RING
C13 (HIGH PRESS.)	LIQUID INJECTION	1 1/16-12 STRAIGHT THREAD O-RING
C14	DISCHARGE PRESSURE	1/4-18 NPTF (DRYSEAL)
C15	OIL PRESSURE	1/8-27 NPTF (DRYSEAL)
D1	LOADING OIL	1/8-27 NPTF (DRYSEAL)
D2	ATMOSPHERIC DRAIN	1/8-27 NPTF (DRYSEAL)
V1	VAPOR INJECTION	WELD FLANGE FOR 1 1/4" PIPE

3. TO SHOW COMPRESSOR WITH OIL PUMP:
TURN OFF LAYER "NO_OIL_PUMP"
TURN ON LAYER "OIL_PUMP"
- TO SHOW COMPRESSOR WITHOUT OIL PUMP:
TURN OFF LAYER "OIL_PUMP"
TURN ON LAYER "NO_OIL_PUMP"
2. HARTFORD COMPRESSORS COUPLING PRACTICE:
HUB BORE = 2.7500 - 2.7495 DIA.
HUB KEYWAY = .750 - .748
SET SCREWS: (1) OVER KEYWAY & (1) 90° AWAY
1. DIMENSION TO END OF INDICATOR COVER APPLIES FOR COMPRESSORS WITH INDICATOR KITS PART NO'S. 054258A3 & 054258A4. IF USING INDICATOR KIT PART NO'S. 054258A1, 054258A2, 054258A5, 054258A6, 054258A7 OR 054258A8 THEN DIMENSION TO END OF INDICATOR COVER IS REDUCED BY 7/8 INCHES.

NOTES:

This drawing contains designs and other information which are the property of HARTFORD COMPRESSORS. This drawing may not, in whole or in part, be duplicated or disclosed or used for manufacture of the part disclosed herein, without prior written permission of HARTFORD COMPRESSORS.

HARTFORD COMPRESSORS
Pioneers in Screw Compressor Technology
179 SOUTH STREET
WEST HARTFORD, CT 06110 U.S.A.

PART NAME: MODEL 2512 "F" VERSION DIMENSIONAL OUTLINE
MATERIAL: CLOSE COUPLED MALE DRIVE
SCALE: 9/64
DRAWN BY: T. BIANCO
DATE: 12/11/98
REVIEWED: []
DATE: []
COMPRESSOR LINE
LSC - 255MM
DRAWING NUMBER: **D5-056178K2**
SHEET 1 OF 1
REV. 1

LSC 255 COMPRESSORS

VERSION 'A', 'B', 'C' AND SOME 'D' MODELS

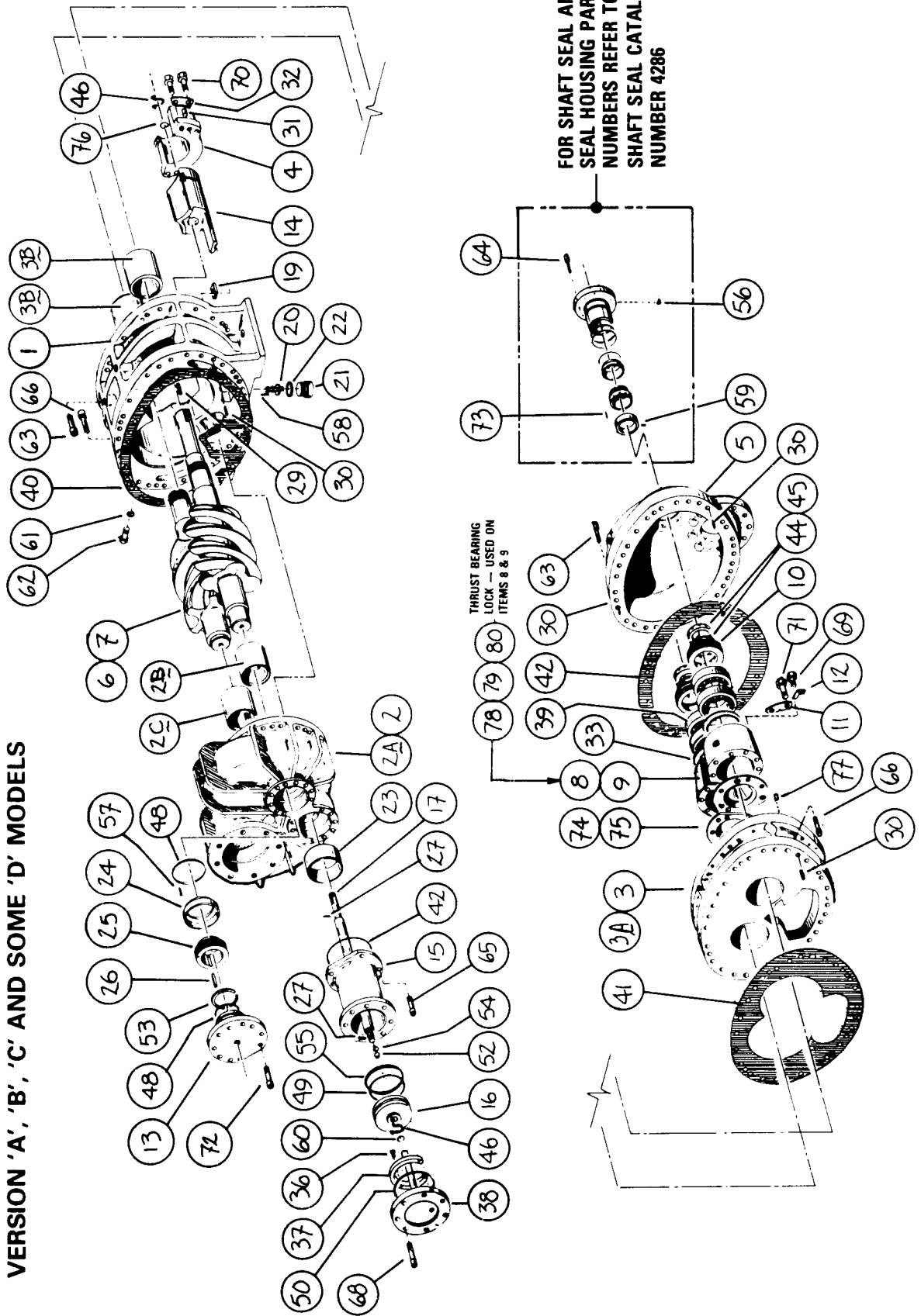

LSC 255 COMPRESSOR PARTS LISTING FOR MODELS 2510, 2512, 2514, 2515 AND 2516 FOR 'A' AND 'B' VERSIONS¹ ONLY.

ITEM	DESCRIPTION	QTY.	(2510)	(2512)	(2514)	(2515)	(2516)
			PART NO.	PART NO.	PART NO.	PART NO.	PART NO.
1	Housing, Rotor	1	HSG100X	HSG74T1	HSG106X	HSG106X	HSG73T1
2	Housing Assembly, Inlet	1	HSG104AX	HSG104AX	HSG104AX	HSG104AX	HSG104AX
2A	Housing, Inlet	1	HSG103X	HSG103X	HSG103X	HSG103X	HSG103X
2B	Bearing, Inlet End - Male Rotor	1	BRG77	BRG77	BRG77	BRG77	BRG77
2C	Bearing, Inlet End - Female Rotor	1	BRG78	BRG78	BRG78	BRG78	BRG78
3	Plate Assembly - Outlet End	1	PLT880AX ¹	PLT880AX ¹	PLT880AX ¹	PLT880AX ¹	PLT880AX ¹
3A	Plate - Outlet End	1	PLT881X	PLT881X	PLT881X	PLT881X	PLT881X
3B	Bearing, Male & Female - Outlet End	2	BRG76	BRG76	BRG76	BRG76	BRG76
4	Guide, Slide	1	GDE14	GDE14	GDE14	GDE14	GDE14
5	Cover, Outlet End	1	COV98X ¹	COV98X ¹	COV98X ¹	COV98X ¹	COV98X ¹
6	Rotor, Male	1	ROR517	ROR35	ROR521	ROR521	ROR31
7	Rotor, Female	1	ROR518	ROR37	ROR522	ROR522	ROR33
8	Sleeve (Bearing), Male	1	SLV31	SLV31	SLV31	SLV31	SLV31
9	Sleeve (Bearing), Female	1	SLV32	SLV32	SLV32	SLV32	SLV32
10	Nut (Bearing)	2	NUT34	NUT34	NUT34	NUT34	NUT34
11	Plate, Locking	4	PLT1047	PLT1047	PLT1047	PLT1047	PLT1047
12	Plate, Locking	2	PLT882	PLT882	PLT882	PLT882	PLT882
13	Cover, Balancing Piston	1	COV99X ¹	COV99X ¹	COV99X ¹	COV99X ¹	COV99X ¹
14	Valve, Sliding (High Temp. Compressor)	1	VAL604 ¹	VAL672	VAL605	VAL605 ¹	VAL605 ¹
14	Valve, Sliding (Low Temp. Compressor)	1	VAL606 ¹	VAL606 ¹	VAL606 ¹	VAL607 ¹	VAL713
15	Cylinder, Unloader Piston	1	CYL21 ¹	CYL21	CYL21	CYL21 ¹	CYL21
16	Piston, Unloader	1	PST73 ¹	PST73	PST73	PST73 ¹	PST73
17	Spindle Assembly	1	SPN4A ¹	SPN7A ¹	SPN5A ¹	SPN5A ¹	SPN6A ¹
18							
19	Guide, Block	1	GDE10	GDE10	GDE10	GDE10	GDE10
20	Spindle, Guide Block	1	SPN3	SPN3	SPN3	SPN3	SPN3
21	Plug, Spindle Guide	1	PLU105	PLU105	PLU105	PLU105	PLU105
22	Gasket, Plug	1	GKT238	GKT238	GKT238	GKT238	GKT238
23	Spacer, Piston	1	SPC120T ¹	SPC120T2	SPC120T3	SPC120T3 ¹	N/R
24	Sleeve, Balance Piston	1	SLV50	SLV50	SLV50	SLV50	SLV50
25	Piston, Balance	1	PST74	PST74	PST74	PST74	PST74
26	Key, Balance Piston	1	KEY5	KEY5	KEY5	KEY5	KEY5
27	Pin, Spring	2	PIN82T3 ¹	PIN82T3	PIN82T3	PIN82T3 ¹	PIN82T3
28							
29	Key, Male Rotor	1	KEY9	KEY9	KEY9	KEY9	KEY9
30	Pin, Dowel	6	054905A1	054905A1	054905A1	054905A1	054905A1
31	Pin, Dowel	2	PIN51T3	PIN51T3	PIN51T3	PIN51T3	PIN51T3
32	Plate, Locking	2	PLT1048	PLT1048	PLT1048	PLT1048	PLT1048
33	Shims (Bearing)	2	SHM12	SHM12	SHM12	SHM12	SHM12
34							
35							
36	Screw, Soc HD Cap	1	N/R	N/R	034P10	N/R	N/R
37	Spacer, Piston	1	N/R	N/R	SPC122	N/R	N/R
38	Plate & Injection Tube Assembly	1	PLT1050AT1 ¹	PLT1050AT2	PLT1050AT2	PLT1050AT2 ¹	PLT1050AT2
39	Bearing, Thrust	4	054996A1	054996A1	054996A1	054996A1	054996A1
40	Gasket (Inlet) - F.F.	1	GKT336X ³	GKT336X ³	GKT336X ³	GKT336X ³	GKT336X ³
41	Gasket (Rotor Housing Outlet) - F.F.	1	GKT337X ⁴	GKT337X ⁴	GKT337X ⁴	GKT337X ⁴	GKT337X ⁴
42	Gasket (Outlet End Cover) - F.F.	1	GKT338X ⁵	GKT338X ⁵	GKT338X ⁵	GKT338X ⁵	GKT338X ⁵
43							
44	Washer, Lock (SAE W-17)	2	WAS67	WAS67	WAS67	WAS67	WAS67
45	Nut, Lock (SAE N-17)	2	NUT35	NUT35	NUT35	NUT35	NUT35
46	Ring, Retaining (Truarc No. 5100-137)	2	RNG142	RNG142	RNG142	RNG142	RNG142
47	"O" Ring (Parker No. 2-440-C-147-7)	1	RNG144	RNG144	RNG144	RNG144	RNG144
48	"O" Ring (Parker No. 2-439-C-147-7)	2	RNG145	RNG145	RNG145	RNG145	RNG145
49	"O" Ring (Parker No. 2-436-C-147-7)	1	RNG146	RNG146	RNG146	RNG146	RNG146
50	"O" Ring (Parker No. 2-365-C-147-7)	1	RNG147	RNG147	RNG147	RNG147	RNG147
51							
52	"O" Ring (Parker No. 2-212-C-147-7)	1	RNG230 ¹	RNG230 ¹	RNG230 ¹	RNG230 ¹	RNG230 ¹
53	Ring, Retaining (Truarc No. 5100-350)	1	RNG143	RNG143	RNG143	RNG143	RNG143
54	Ring - Slipper Seal	1	RNG229 ¹	RNG229 ¹	RNG229 ¹	RNG229 ¹	RNG229 ¹
55	Ring - Slipper Seal	1	RNG132	RNG132	RNG132	RNG132	RNG132
56	Elbow - 90°	1	ELL75 ¹	ELL75 ¹	ELL75 ¹	ELL75 ¹	ELL75 ¹
57	Pin, Dowel - 3/16 Dia. x 1/2 Lg.	1	0602P03	0602P03	0602P03	0602P03	0602P03
58	Pin, Spring - 3/16 Dia. x 7/8 Lg.	1	PIN53	PIN53	PIN53	PIN53	PIN53
59	Pin, Spring - 1/8 Dia. x 3/8 Lg.	1	PIN80T3	PIN80T3	PIN80T3	PIN80T3	PIN80T3
60	"O" Ring (Parker No. 2-220-C-147-7)	1	RNG275 ¹	RNG275 ¹	RNG275 ¹	RNG275 ¹	RNG275 ¹
61	Gasket (Nozzle)	1	GKT245X ¹	N/R	GKT245X ¹	GKT245X ¹	N/R
62	Nozzle (Oil Injection)	1	NOZ2XT1 ¹	N/R	NOZ2XT2 ¹	NOZ2XT2 ¹	N/R
63	Screw, Soc HD Cap - 5/8 - 11 x 2 1/2	55	0348P23 ¹	0348P23	0348P23	0348P23 ¹	0348P23
64	Screw, Soc HD Cap - 3/8 - 16 x 1 1/4	6	036P13	036P13	036P13	036P13	036P13
65	Screw, Soc HD Cap - 5/8 - 11 x 1 3/4	10	0348P17	0348P17	0348P17	0348P17	0348P17
66	Screw, Soc HD Cap - 5/8 - 11	32	0348P21 ¹	0348P21	0348P21	0348P21 ¹	0348P21
67							
68	Screw, Soc HD Cap - 5/8 - 11 x 2 3/4 Lg.	8	0348P25	0348P25	0348P25	0348P25	0348P25
69	Screw, Hex HD Cap - 3/8 - 16 x 5/8 Lg.	2	012P07	012P07	012P07	012P07	012P07
70	Screw, Hex HD Cap - 3/8 - 16 x 1 1/2 Lg.	4	012P15	012P15	012P15	012P15	012P15
71	Screw, Hex HD Cap - 1/2 - 13 x 5 1/2 Lg.	8	014P47	014P47	014P47	014P47	014P47
72	Screw, Soc HD Cap - 5/8 - 11 x 2 Lg.	10	0348P19 ¹	0348P19	0348P19	0348P19 ¹	0348P19
73	Pin, Spring - 1/8 Dia. x 3/4 Lg.	1	PIN80T6	PIN80T6	PIN80T6	PIN80T6	PIN80T6
74	Plate, Bearing - Male	1	PLT883	PLT883	PLT883	PLT883	PLT883
75	Plate, Bearing - Female	1	PLT884	PLT884	PLT884	PLT884	PLT884
76	Shim	AR	6	6	6	6	6
77							

¹ Consult Factory - part number varies with application and accessories.

² Low temperature version not available with this compressor.

³ GKT446 can be used by trimming internal oil tab.

⁴ GKT447 can be used.

⁵ GKT448 can be used by trimming internal oil tab.

⁶ Use combination of SHM19T1 and SHM19T2 to obtain approximately .004 axial cir.

LSC 255 COMPRESSOR PARTS LISTING FOR MODELS 2509, 2510, 2512, 2514, 2515 AND 2516 FOR 'C' VERSION¹ ONLY.

ITEM	DESCRIPTION	QTY.	(2509)	(2510)	(2512)	(2514)	(2515)	(2516)
			PART NO.	PART NO.	PART NO.	PART NO.	PART NO.	PART NO.
1	Housing, Rotor	1	HSG100T1	HSG100T1	HSG140T1	HSG106T1	HSG106T1	HSG73T1
2	Housing Assembly, Inlet	1	HSG103AT1	HSG103AT1	HSG103AT1	HSG103AT1	HSG103AT1	HSG103AT1
2A	Housing, Inlet	1	HSG103T1	HSG103T1	HSG103T1	HSG103T1	HSG103T1	HSG103T1
2B	Bearing, Inlet End - Male Rotor	1	BRG77	BRG77	BRG77	BRG77	BRG77	BRG77
2C	Bearing, Inlet End - Female Rotor	1	BRG78	BRG78	BRG78	BRG78	BRG78	BRG78
3	Plate Assembly - Outlet End (Ultra-Low Temperature)	1	3	PLT2153AT1	PLT2153AT1	3	PLT2153AT1	PLT2153AT1
3	Plate Assembly - Outlet End (Hi & Low Temperature)	1	PLT2017AT1	PLT2017AT1	PLT2017AT1	PLT2017AT1	PLT2017AT1	PLT2017AT1
3A	Plate - Outlet End (Hi & Low Temp.)	1	PLT2017T1	PLT2017T1	PLT2017T1	PLT2017T1	PLT2017T1	PLT2017T1
3B	Bearing, Male & Female - Outlet End	2	BRG76	BRG76	BRG76	BRG76	BRG76	BRG76
4	Guide, Slide	1	GDE14	GDE14	GDE14	GDE14	GDE14	GDE14
5	Cover, Outlet End	1	COV98T1	COV98T1	COV98T1	COV98T1	COV98T1	COV98T1
6	Rotor, Male	1	ROR563	ROR563	ROR565	ROR567	ROR567	ROR569
7	Rotor, Female	1	ROR564	ROR564	ROR566	ROR567	ROR567	ROR570
8	Sleeve (Bearing), Male	1	SLV31	SLV31	SLV31	SLV31	SLV31	SLV31
9	Sleeve (Bearing), Female	1	SLV32	SLV32	SLV32	SLV32	SLV32	SLV32
10	Nut (Bearing)	2	NUT34	NUT34	NUT34	NUT34	NUT34	NUT34
11	Plate, Locking	4	PLT1047	PLT1047	PLT1047	PLT1047	PLT1047	PLT1047
12	Plate, Locking	2	PLT882	PLT882	PLT882	PLT882	PLT882	PLT882
13	Cover, Balancing Piston	1	COV99 ⁴	COV99 ⁴	COV99 ⁴	COV99 ⁴	COV99 ⁴	COV99 ⁴
14	Valve, Sliding (High Temp. Compressor)	1	VAL743T4	VAL743T4	VAL744T4	VAL745T4	VAL745T4	VAL746T4
14	Valve, Sliding (Low Temp. Compressor)	1	2	VAL743T3	VAL744T3	2	VAL745T3	VAL746T3
14	Valve, Sliding (Ultra-Low Temp.)	1	3	VAL743T1	VAL744T1	3	VAL745T1	VAL746T1
15	Cylinder, Unloader Piston	1	CYL21	CYL21	CYL21	CYL21	CYL21	CYL21
16	Piston, Unloader	1	PST73	PST73	PST73	PST73	PST73	PST73
17	Spindle Assembly	1	SPN7A	SPN4A	SPN7A	SPN5A	SPN5A	SPN6A
18								
19	Guide, Block	1	GDE10	GDE10	GDE10	GDE10	GDE10	GDE10
20	Spindle, Guide Block	1	SPN3	SPN3	SPN3	SPN3	SPN3	SPN3
21	Plug, Spindle Guide	1	PLU105	PLU105	PLU105	PLU105	PLU105	PLU105
22	Gasket, Plug	1	GKT238	GKT238	GKT238	GKT238	GKT238	GKT238
23	Spacer, Piston	1	SPC120T1	SPC120T1	SPC120T2	SPC120T3	SPC120T3	N/R
24	Sleeve, Balance Piston	1	SLV50	SLV50	SLV50	SLV50	SLV50	SLV50
25	Piston, Balance	1	PST74	PST74	PST74	PST74	PST74	PST74
26	Key, Balance Piston	1	KEY5	KEY5	KEY5	KEY5	KEY5	KEY5
27	Pin, Spring	2	PIN82T3	PIN82T3	PIN82T3	PIN82T3	PIN82T3	PIN82T3
28								
29	Key, Male Rotor	1	KEY9	KEY9	KEY9	KEY9	KEY9	KEY9
30	Pin, Dowel	6	054905A1	054905A1	054905A1	054905A1	054905A1	054905A1
31	Pin, Dowel	2	PIN51T3	PIN51T3	PIN51T3	PIN51T3	PIN51T3	PIN51T3
32	Plate, Locking	2	PLT1048	PLT1048	PLT1048	PLT1048	PLT1048	PLT1048
33	Shims (Bearing)	2	SHM12	SHM12	SHM12	SHM12	SHM12	SHM12
34								
35								
36	Screw, Soc HD Cap	2	034P10	N/R	N/R	034P10	N/R	N/R
37	Spacer, Piston	1	SPC142T1	N/R	N/R	SPC122	N/R	N/R
38	Plate & Injection Tube Assembly	1	PLT1050AT1	PLT1050AT1	PLT1050AT2	PLT1050AT2	PLT1050AT2	PLT1050AT2
39	Bearing, Thrust	4	054996A1	054996A1	054996A1	054996A1	054996A1	054996A1
40	Gasket (Inlet) - F.F.	1	GKT446	GKT446	GKT446	GKT446	GKT446	GKT446
41	Gasket (Rotor Housing Outlet) - F.F.	1	GKT447	GKT447	GKT447	GKT447	GKT447	GKT447
42	Gasket (Outlet End Cover) - F.F.	1	GKT448	GKT448	GKT448	GKT448	GKT448	GKT448
43								
44	Washer, Lock (SAE W-17)	2	WAS67	WAS67	WAS67	WAS67	WAS67	WAS67
45	Nut, Lock (SAE N-17)	2	NUT35	NUT35	NUT35	NUT35	NUT35	NUT35
46	Ring, Retaining (Truarc No. 5160-137)	2	RNG286	RNG286	RNG286	RNG286	RNG286	RNG286
47	"O" Ring (Parker No. 2-440-C-147-7)	1	RNG144	RNG144	RNG144	RNG144	RNG144	RNG144
48	"O" Ring (Parker No. 2-439-C-147-7)	2	RNG145	RNG145	RNG145	RNG145	RNG145	RNG145
49	"O" Ring (Parker No. 2-436-C-147-7)	1	RNG146	RNG146	RNG146	RNG146	RNG146	RNG146
50	"O" Ring (Parker No. 2-365-C-147-7)	1	RNG147	RNG147	RNG147	RNG147	RNG147	RNG147
51								
52	"O" Ring (Parker No. 2-118-C-147-7)	1	RNG256	RNG256	RNG256	RNG256	RNG256	RNG256
53	Ring, Retaining (Truarc No. 5100-350)	1	RNG143	RNG143	RNG143	RNG143	RNG143	RNG143
54	Ring - Slipper Seal	1	RNG255	RNG255	RNG255	RNG255	RNG255	RNG255
55	Ring - Slipper Seal	1	RNG132	RNG132	RNG132	RNG132	RNG132	RNG132
56	Elbow - 90°	1	ELL136T1	ELL136T1	ELL136T1	ELL136T1	ELL136T1	ELL136T1
57	Pin, Dowel - 3/16 Dia. x 1/2 Lg.	1	0602P03	0602P03	0602P03	0602P03	0602P03	0602P03
58	Pin, Spring - 3/16 Dia. x 7/8 Lg.	1	PIN53	PIN53	PIN53	PIN53	PIN53	PIN53
59	Pin, Spring - 1/8 Dia. x 3/4 Lg.	1	PIN80T3	PIN80T3	PIN80T3	PIN80T3	PIN80T3	PIN80T3
60	"O" Ring (Parker No. 2-220-C-147-7)	1	RNG275	RNG275	RNG275	RNG275	RNG275	RNG275
61								
62								
63	Screw, Soc HD Cap - 5/8 - 11 x 2 1/2 Lg.	55	0348P23	0348P23	0348P23	0348P23	0348P23	0348P23
64	Screw, Soc HD Cap - 3/8 - 16 x 1 1/4 Lg.	6	036P13	036P13	036P13	036P13	036P13	036P13
65	Screw, Soc HD Cap - 5/8 - 11 x 1 3/4 Lg.	10	0348P17	0348P17	0348P17	0348P17	0348P17	0348P17
66	Screw, Soc HD Cap - 5/8 - 11 x 2 1/4 Lg.	32	0348P21	0348P21	0348P21	0348P21	0348P21	0348P21
67								
68	Screw, Soc HD Cap - 5/8 - 11 x 2 3/4 Lg.	8	0348P25	0348P25	0348P25	0348P25	0348P25	0348P25
69	Screw, Hex HD Cap - 3/8 - 16 x 5/8 Lg.	2	012P07	012P07	012P07	012P07	012P07	012P07
70	Screw, Hex HD Cap - 3/8 - 16 x 1 1/2 Lg.	4	012P15	012P15	012P15	012P15	012P15	012P15
71	Screw, Hex HD Cap - 1/2 - 13 x 5 1/2 Lg.	8	014P47	014P47	014P47	014P47	014P47	014P47
72	Screw, Soc HD Cap - 5/8 - 11 x 2 Lg.	10	0348P19	0348P19	0348P19	0348P19	0348P19	0348P19
73	Pin, Spring - 1/8 Dia. x 3/4 Lg.	1	PIN80T6	PIN80T6	PIN80T6	PIN80T6	PIN80T6	PIN80T6
74	Plate, Bearing - Male	1	PLT883	PLT883	PLT883	PLT883	PLT883	PLT883
75	Plate, Bearing - Female	1	PLT884	PLT884	PLT884	PLT884	PLT884	PLT884
76	Shim	AR	5	5	5	5	5	5
77								

¹ Consult Factory - part number varies with application and accessories

² Low temperature version not available with this compressor

³ Ultra-Low temperature version not available with this compressor

⁴ Specify cover with 4 tapped oil holes

⁵ Use combination of SHM19T1 and SHM19T2 to obtain approx. .004 min. axial chr.

LSC 255 COMPRESSOR PARTS LISTING FOR MODELS 2509, 2510, 2512, 2514, 2515 AND 2516 FOR 'D' VERSION¹ ONLY.

ITEM	DESCRIPTION	QTY.	(2509)	(2510)	(2512)	(2514)	(2515)	(2516)
			PART NO.	PART NO.	PART NO.	PART NO.	PART NO.	PART NO.
1	Housing, Rotor	1	HSG100AT3	HSG100AT3	HSG140AT3	HSG106AT3	HSG106AT3	HSG73AT3
2	Housing Assembly, Inlet	1	HSG103AT2	HSG103AT2	HSG103AT2	HSG103AT2	HSG103AT2	HSG103AT2
2A								
2B	Bearing, Inlet End — Male Rotor	1	BRG77	BRG77	BRG77	BRG77	BRG77	BRG77
2C	Bearing, Inlet End — Female Rotor	1	BRG78	BRG78	BRG78	BRG78	BRG78	BRG78
3	Plate Assembly — Outlet End (Ultra-Low Temperature)	1	³	PLT2153AT2	PLT2153AT2	³	PLT2153AT2	PLT2153AT2
3A	Plate Assembly — Outlet End (Hi & Low Temperature)	1	PLT2017AT2	PLT2017AT2	PLT2017AT2	PLT2017AT2	PLT2017AT2	PLT2017AT2
3B	Bearing, Male & Female — Outlet End	2	BRG76	BRG76	BRG76	BRG76	BRG76	BRG76
4	Guide, Slide	1	GDE14	GDE14	GDE14	GDE14	GDE14	GDE14
5	Cover, Outlet End — Type 9B Seal	1	COV98T3	COV98T3	COV98T3	COV98T3	COV98T3	COV98T3
	Cover, Outlet End — Type 8B Seal	1	COV98T4	COV98T4	COV98T4	COV98T4	COV98T4	COV98T4
6	Rotor, Male	1	SET69T4	SET69T4	SET70T4	SET71T4	SET71T4	SET72T4
7	Rotor, Female	1	SET69T4	SET69T4	SET70T4	SET71T4	SET71T4	SET72T4
8	Sleeve (Bearing), Male	1	SLV31T2	SLV31T2	SLV31T2	SLV31T2	SLV31T2	SLV31T2
9	Sleeve (Bearing), Female	1	SLV32T2	SLV32T2	SLV32T2	SLV32T2	SLV32T2	SLV32T2
10	Nut (Bearing)	2	NUT34	NUT34	NUT34	NUT34	NUT34	NUT34
11	Plate, Locking - Sleeve	4	PLT1047	PLT1047	PLT1047	PLT1047	PLT1047	PLT1047
12	Plate, Locking - Nut	2	PLT2227	PLT2227	PLT2227	PLT2227	PLT2227	PLT2227
13	Cover, Balancing Piston	1	COV99	COV99	COV99	COV99	COV99	COV99
14	Valve, Sliding (High Temp. Compressor)	1	VAL743T4	VAL743T4	VAL744T4	VAL745T4	VAL745T4	VAL746T4
	Valve, Sliding (Low Temp. Compressor)	1	²	VAL743T3	VAL744T3	²	VAL745T3	VAL746T3
	Valve, Sliding (Ultra-Low Temp. Comp.)	1	³	VAL743T1	VAL744T1	³	VAL745T1	VAL746T1
15	Cylinder, Unloader Piston	1	CYL29T4	CYL29T4	CYL29T4	CYL29T4	CYL29T4	CYL29T4
16	Piston, Unloader	1	053136A1	053136A1	053136A1	053136A1	053136A1	053136A1
17	Spindle Assembly	1	SPN18AT8	SPN18AT8	SPN18AT9	SPN18AT10	SPN18AT10	SPN18AT11
18								
19	Guide, Block*	1	GDE10*	GDE10*	GDE10*	GDE10*	GDE10*	GDE10*
20	Spindle, Guide Block	1	SPN3	SPN3	SPN3	SPN3	SPN3	SPN3
21	Plug, Spindle Guide Block	1	PLU105	PLU105	PLU105	PLU105	PLU105	PLU105
22	Gasket, Plug - Spindle	1	GKT238	GKT238	GKT238	GKT238	GKT238	GKT238
23	Spacer, Piston - Unloader	1	SPC120T1	SPC120T1	SPC120T2	SPC120T3	SPC120T3	N/R
24	Sleeve, Balancing Piston	1	SLV60	SLV60	SLV60	SLV60	SLV60	SLV60
25	Piston, Balancing	1	PST74	PST74	PST74	PST74	PST74	PST74
26	Key, Balancing Piston	1	KEY5	KEY5	KEY5	KEY5	KEY5	KEY5
27	Pin, Spring - Spindle	2	PIN82T3	PIN82T3	PIN82T3	PIN82T3	PIN82T3	PIN82T3
28								
29	Key, Male Rotor	1	KEY9	KEY9	KEY9	KEY9	KEY9	KEY9
30	Pin, Dowel	6	054905A1	054905A1	054905A1	054905A1	054905A1	054905A1

¹ Consult Factory — part number varies with applications and accessories.

² Low temperature version not available with this compressor.

³ Ultra-Low temperature version not available with this compressor.

⁴ Use combination of SHM19T1 and SHM19T2 to obtain approx. .004 min. axial clr.

⁵ Use combination of SHM21T21, T22, T23, T24 and T25 to obtain approximately .004 to .006 rotor discharge end clearance.

* GDE32 Oversize Slide Valve Guide Block.

NOTE: LSC 255D ITEM NUMBERS 31 THRU 80 NEXT PAGE

LSC 255 COMPRESSOR PARTS LISTING FOR MODELS 2509, 2510, 2512, 2514, 2515 AND 2516 FOR 'D' VERSION¹ ONLY (Cont.)

ITEM	DESCRIPTION	QTY.	(2509)	(2510)	(2512)	(2514)	(2515)	(2516)
			PART NO.	PART NO.	PART NO.	PART NO.	PART NO.	PART NO.
31	Pin, Dowel - Slide Guide	2	PIN51T3	PIN51T3	PIN51T3	PIN51T3	PIN51T3	PIN51T3
32	Plate, Locking - Slide Guide	2	PLT1048	PLT1048	PLT1048	PLT1048	PLT1048	PLT1048
33	Shim, Bearing Thrust	AR	5	5	5	5	5	5
34								
35								
36	Screw, Soc HD Cap	2	034P10	034P10	034P10	034P10	034P10	034P10
37	Spacer, Piston - Unloader	1	SPC142T1	N/R	SPC122	N/R	N/R	N/R
38	Plate & Injection Tube Assembly	1	053199A1	053199A1	053199A2	053199A2	053199A2	053199A2
39	Bearing, Thrust	4	054996A1	054996A1	054996A1	054996A1	054996A1	054996A1
40	Gasket (Inlet)	1	GKT446	GKT446	GKT446	GKT446	GKT446	GKT446
41	Gasket (Rotor Housing Outlet)	1	GKT447	GKT447	GKT447	GKT447	GKT447	GKT447
42	Gasket (Outlet End Cover)	1	GKT448	GKT448	GKT448	GKT448	GKT448	GKT448
43								
44	Washer, Lock (SAE W-17)	2	WAS67	WAS67	WAS67	WAS67	WAS67	WAS67
45	Nut, Lock (SAE N-17)	2	NUT35	NUT35	NUT35	NUT35	NUT35	NUT35
46	Ring, Retaining (Truarc No. 5160-137)	2	RNG286	RNG286	RNG286	RNG286	RNG286	RNG286
47	"O" Ring (Parker No. 2-440-C-147-7)	1	RNG144	RNG144	RNG144	RNG144	RNG144	RNG144
48	"O" Ring (Parker No. 2-439-C-147-7)	2	RNG145	RNG145	RNG145	RNG145	RNG145	RNG145
49	"O" Ring (Parker No. 2-436-C-147-7)	1	RNG146	RNG146	RNG146	RNG146	RNG146	RNG146
50	"O" Ring (Parker No. 2-365-C-147-7)	1	RNG147	RNG147	RNG147	RNG147	RNG147	RNG147
51								
52	"O" Ring (Parker No. 2-118-C-147-7)	1	RNG256	RNG256	RNG256	RNG256	RNG256	RNG256
53	Ring, Retaining (Truarc No. 5100-350)	1	RNG143	RNG143	RNG143	RNG143	RNG143	RNG143
54	Ring - Slipper Seal, - Spindle	1	RNG255	RNG255	RNG255	RNG255	RNG255	RNG255
55	Ring - Slipper Seal - Unloader Piston	1	RNG132	RNG132	RNG132	RNG132	RNG132	RNG132
56	Elbow - 90° - Seal Housing	1	ELL136T1	ELL136T1	ELL136T1	ELL136T1	ELL136T1	ELL136T1
57	Pin, Dowel - 3/16 Dia. x 1/2 Lg.	1	0602P03	0602P03	0602P03	0602P03	0602P03	0602P03
58	Pin, Spring - 3/16 Dia. x 7/8 Lg.	1	PIN53	PIN53	PIN53	PIN53	PIN53	PIN53
59	Pin, Spring - 1/8 Dia x 3/ 8 Lg.	1	PIN80T3	PIN80T3	PIN80T3	PIN80T3	PIN80T3	PIN80T3
60	"O" Ring (Parker No. 2-220-C-147-7)	1	RNG275	RNG275	RNG275	RNG275	RNG275	RNG275
61								
62								
63	Screw, Soc HD Cap - 5/8 - 11 x 2 1/2 Lg.	55	0348P23	0348P23	0348P23	0348P23	0348P23	0348P23
64	Screw, Soc HD Cap - 3/8 - 16 x 1 1/4 Lg.	6	036P13	036P13	036P13	036P13	036P13	036P13
65	Screw, Soc HD Cap - 5/8 - 11 x 1 3/4 Lg.	10	0348P17	0348P17	0348P17	0348P17	0348P17	0348P17
66	Screw, Soc HD Cap - 5/8 - 11 x 2 1/4 Lg.	32	0348P21	0348P21	0348P21	0348P21	0348P21	0348P21
67	Seal, Lip - Type 9B Seal	1	SEL66	SEL66	SEL66	SEL66	SEL66	SEL66
68	Screw, Soc HD Cap - 5/8 - 11 x 2 3/4" Lg.	8	0348P25	0348P25	0348P25	0348P25	0348P25	0348P25
69	Screw, Hex HD Cap - 3/8 - 16 x 5/8" Lg.	2	012P07	012P07	012P07	012P07	012P07	012P07
70	Screw, Hex HD Cap - 3/8 - 16 x 1 1/2" Lg.	4	012P15	012P15	012P15	012P15	012P15	012P15
71	Screw, Hex HD Cap - 1/2 - 13 x 5 1/2" Lg.	8	014P47	014P47	014P47	014P47	014P47	014P47
72	Screw, Soc HD Cap - 5/8 - 11 x 2" Lg.	10	0348P19	0348P19	0348P19	0348P19	0348P19	0348P19
73	Pin, Spring, - 1/8 Dia. x 3/4 Lg.	1	PIN80T6	PIN80T6	PIN80T6	PIN80T6	PIN80T6	PIN80T6
74	Plate, Bearing - Male	1	PLT883	PLT883	PLT883	PLT883	PLT883	PLT883
75	Plate, Bearing - Female	1	PLT884	PLT884	PLT884	PLT884	PLT884	PLT884
76	Shim, Spindle	AR	4	4	4	4	4	4
77	Plug, Pipe	1	PLU142T5	PLU142T5	PLU142T5	PLU142T5	PLU142T5	PLU142T5
78	Screw, Set - 3/8 - 16 x 1 3/4" Lg.	2	SCR176	SCR176	SCR176	SCR176	SCR176	SCR176
79	Nut, Hex - 3/8" x 16	2	012P00	012P00	012P00	012P00	012P00	012P00
80	Washer, Split Lock - 3/8"	2	012P01	012P01	012P01	012P01	012P01	012P01

¹ Consult Factory — part number varies with applications and accessories.

² Low temperature version not available with this compressor.

³ Ultra-Low temperature version not available with this compressor.

⁴ Use combination of SHM19T1 and SHM19T2 to obtain approx. .004 min. axial clr.

⁵ Use combination of SHM21T1, T2, T23, T24 and T25 to obtain approximately .004 to .006 rotor discharge end clearance.

* GDE32 Oversize Slide Valve Guide Block.

LSC
255E
REF. DRWG.
A

LSC 255 'E' & 'F' COMPRESSOR EXPLODED VIEW OF SUCTION HOUSING AND BALANCE PISTON SECTION

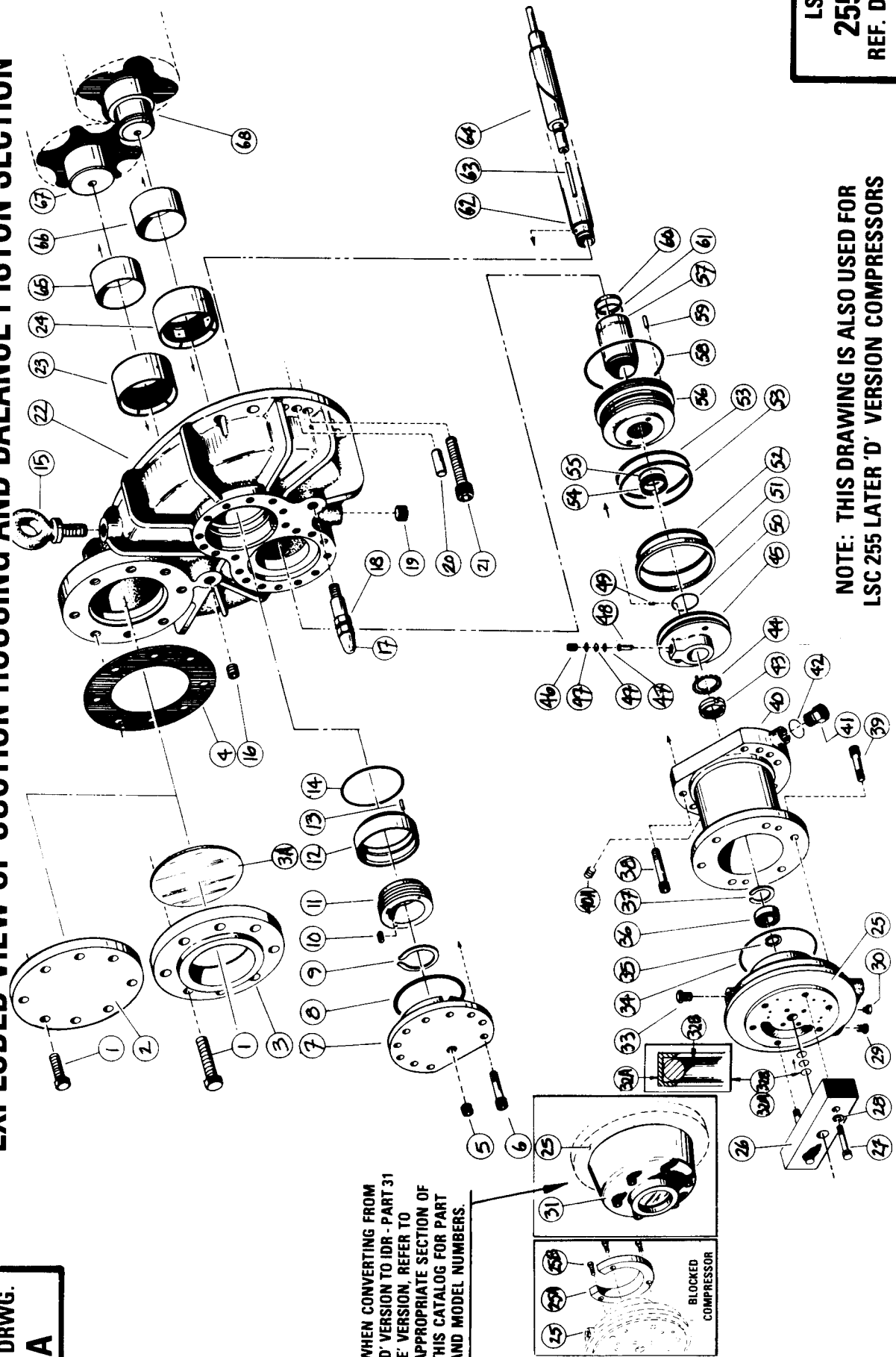

WHEN CONVERTING FROM 'D' VERSION TO IDR - PART 31 'E' VERSION, REFER TO APPROPRIATE SECTION OF THIS CATALOG FOR PART AND MODEL NUMBERS.

NOTE: THIS DRAWING IS ALSO USED FOR LSC 255 LATER 'D' VERSION COMPRESSORS

LSC
255E
REF. DRWG.
A

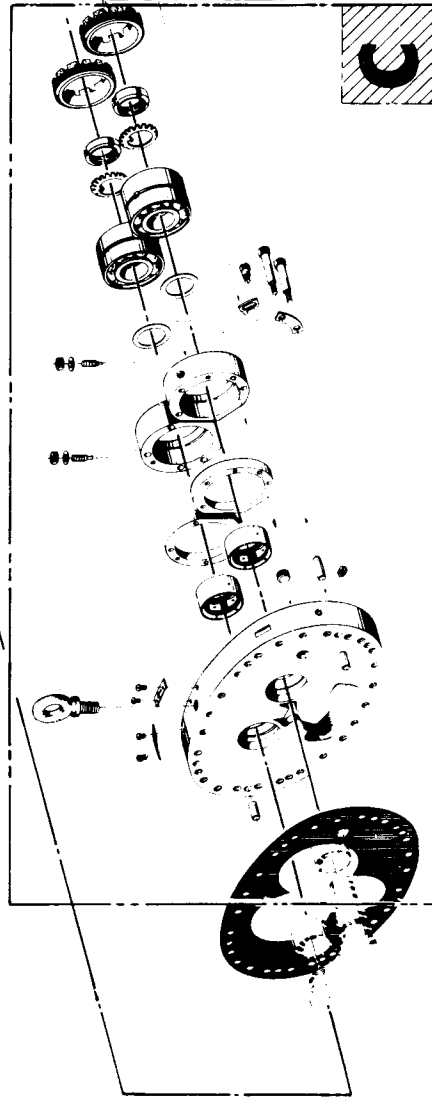
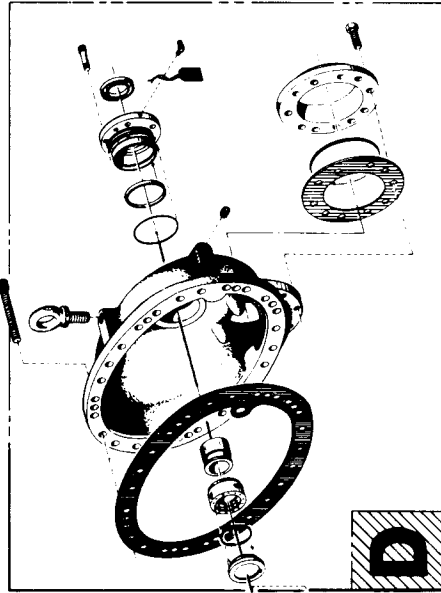
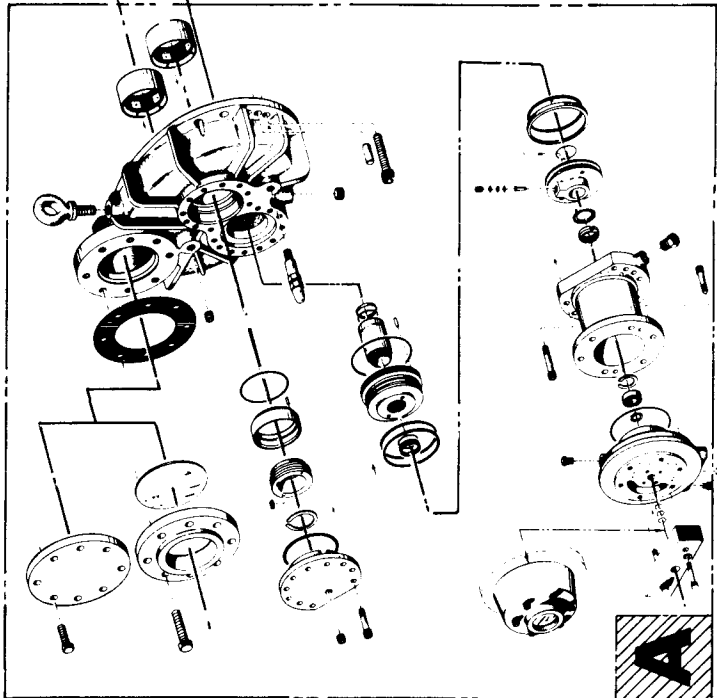
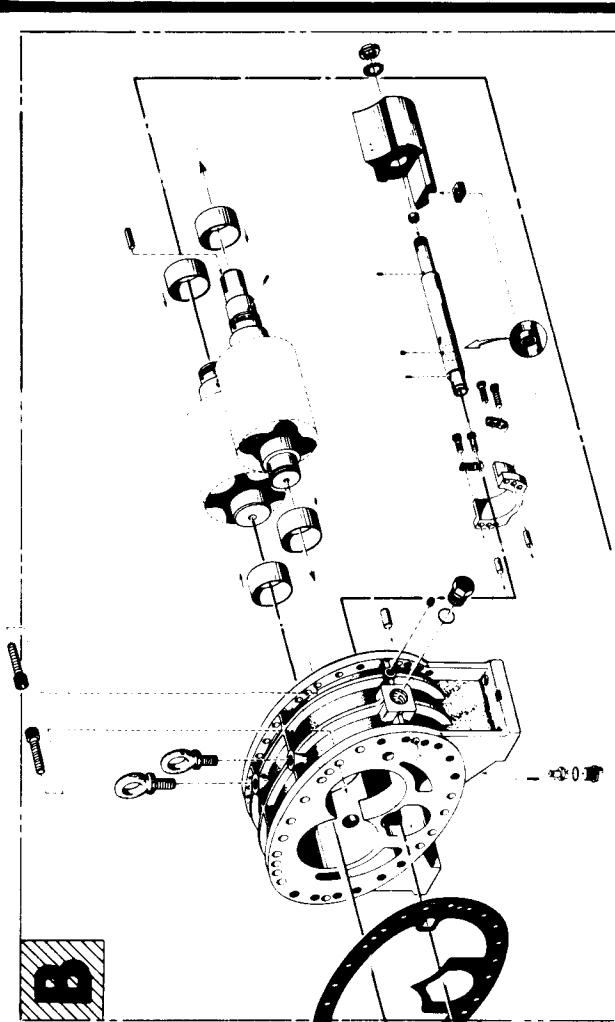

LSC 255 MASTER DRAWING FOR 'D' AND 'E'
MODELS. FOR SECTIONS 'A' THRU 'D' REFER
TO PAGES 37 THRU 40.

LSC 255mm COMPRESSORS – REF. DRAWING 'A'

PARTS LISTING FOR MODELS: 2510, 2512, 2515, 2516, 2519 & 2522 'E' & 'F' VERSION MODELS

No.	DESCRIPTION	'E' VERSION PART NO.	'F' VERSION PART NO.
1	Hex Head Cap Screw For Suction Flange/Disc	(4) 017P13	(4) 017P13
2	Flange Cover Disc Plate	DIS54T6	DIS54T6
3	Suction Flange Cover	FLG107	FLG107
3A	Cover Disc	DIS48	DIS48
4	Suction Cover Gasket	GKT380	GKT380
5	Unloader Oil Supply Port Plug (C12)	055P72	055P72
6	Balance Piston Socket Head Cap Screws	(10) 0348P19	(10) 0348P19
7	Balance Piston Cover (Without oil Pump)	COV99	COV99
8	Balance Piston Cover O-Ring	RNG145	RNG145
9	Balance Piston Retaining Ring	RNG143	RNG143
10	Balance Piston Key	KEY5	KEY5
11	Balance Piston	PST74	PST74
12	Balance Piston Sleeve	SLV60	SLV60
13	Balance Piston Sleeve Dowel Pin	0602P03	0602P03
14	Balance Piston Sleeve O-Ring	RNG145	RNG145
15	Lifting Eye Bolt Std. 5/8" – 11 x 3/4" long	BLT89	BLT89
16	Bearing Oil Feed Plug (C3)	055P72	055P72
17	Suction Pressure Port Bleedoff Holding Charge Valve (C2)	0212P02	0212P02
18	Suction Pressure Port Bleedoff Plug (C2)	055P71	055P71
19	Alternate Suction Pressure Port Bleedoff Plug (C2 Alt.)	055P72	055P72
20	Inlet Housing Dowel Pin	(2) 051071A9	(2) 051071A9
21	Inlet Housing Socket Head Cap Screw 2-1/4" long	(11) 0348P21	(11) 0348P21
	Inlet Housing Socket Head Cap Screw 2-1/2" long	(18) 0348P23	(18) 0348P23
22	Inlet Housing	HSG103A	055625A1
23	Female Inlet Journal Bearing	BRG78	055624A1

LSC 255mm COMPRESSORS – REF. DRAWING 'A' PARTS LISTING FOR MODELS: 2510, 2512, 2515, 2516, 2519 & 2522 'E' & 'F' VERSION MODELS

No.	DESCRIPTION	'E' VERSION PART NO.	'F' VERSION PART NO.
24	Male Inlet Journal Bearing	BRG77	055623A1
25	Unloader Cover	054177A1	054177A1
26	Industrial Indicator Shaft Protection Block	054601A1	054600A1
27	Industrial Indicator Block Hex Head Cap Screw	012P33	Incl. In 054600A1
28	Industrial Indicator Block Retainer	012P03	Incl. In 054600A1
29	Electrical Conduit Protection Plug	055P84	055P84
30	Atmospheric Drain Plug (D2)	055P80	055P80
31	Industrial Slide Valve Indicator Assembly	See IDR Section	See IDR Section
32	Unloader Cover Internal Teflon Capseal	054150A2	054150A2
33	Unloader Oil Port Plug (C5)	055P81	055P81
34	Unloader Cover External O-Ring	RNG147	RNG147
35	Unloader External Retaining Ring	0601P01	0601P01
36	Unloader Radial Bearing	054094A1	054094A1
37	Unloader Internal Retaining Ring	051478A3	051478A3
38	Unloader Cylinder Inboard Socket Head Cap Screws	(10) 0348P25	(10) 0348P25
39	Unloader Cylinder Outboard Socket Head Cap Screws Models: 2510, 2512, 2515, 2516 Models : 2519 & 2522	(8) 0348P19 (8) 051166D5	(8) 0348P19 (8) 051166D5
40	Unloader Cylinder: Later "E" Version Models: 2510, 2512, 2515, 2516 Models : 2519 & 2522	054190A2 054190A3	054190A2 054190A3
41	Main Oil Injection Port (C6)	PLU136	051034A3 4 Bolt Flange
42	Main Oil Injection Port O-Ring/Gasket (C6)	050325A1 O-Ring	054955A1 Flange Gasket
43	Unloader Piston Locknut	054250A1	054250A1
44	Unloader Piston Lockwasher	054251A1	054251A1
45	Unloader Piston	055495A1	055495A1
46	Unloader Piston Indicator Pin Set Screw	054093A1	054093A1
47	Belleville Washers (3 Required installed face down / face up / face down)	(3) 054092A1	(3) 054092A1
48	Unloader Piston Indicator Pin	054089A1	054089A1

LSC 255mm COMPRESSORS – REF. DRAWING 'A'

PARTS LISTING FOR MODELS: 2510, 2512, 2515, 2516, 2519 & 2522 'E' & 'F' VERSION MODELS

49	Spindle Locking Pin	PIN82T3	PIN82T3
50	Unloader Piston Internal O-Ring	RNG254	RNG254
51	Unloader Piston External Teflon Capseal	RNG132	RNG132
52	Unloader Piston External O-Ring	RNG146	RNG146
53	Cylinder Plate Internal O-Ring	(2) RNG165	(2) RNG165
54	Bulkhead Internal Capseal	054150A3	054150A3
55	Bulkhead Internal O-Ring	050133E3	050133E3
56	Bulkhead Cylinder Plate	055325A7	055325A7
57	Bulkhead Tube Assembly	054289A2	054289A2
58	Bulkhead External O-Ring	050133E6	050133E6
59	Bulkhead Cylinder Dowel Pin	051027A2	051027A2
60	Tube Assembly Teflon Capseal	054150A3	054150A3
61	Tube Assembly O-Ring	050133E3	050133E3
62	Spindle : Model 2510 Model 2512 Model 2515 Model 2516 Model 2519 Model 2522	054873A8 054873A9 054873B1 054873B2 054873B5 054873B6	054873A8 054873A9 054873B1 054873B2 054873B5 054873B6
63	Helical Grooved Shaft IDR Extension	054719A1	054719A1
64	Helical Grooved Shaft: Models 2510 & 2512 Models 2515 & 2516 Models 2519 & 2522	054876A8 054876A4 054876A9	054876A8 054876A4 054876A9
65	Inlet End Female Rotor Sleeve	054952A6	054952A6
66	Inlet End Male Rotor Sleeve	054952A5	054952A5
67 & 68	Rotor Set (Includes Male and Female Rotor) Model 2510 Model 2512 Model 2515 Model 2516 Model 2519 Model 2522	SET69T4 SET70T4 SET71T4 SET72T4 055080A4 055080D7	SET69T4 SET70T4 SET71T4 SET72T4 055080A4 055080D7

LSC 255 'E' & 'F' COMPRESSOR EXPLODED VIEW OF ROTOR HOUSING AND SLIDE VALVE SECTION

LSC
255E
REF. DRWG.
B

LSC
255E
REF. DRWG.
B

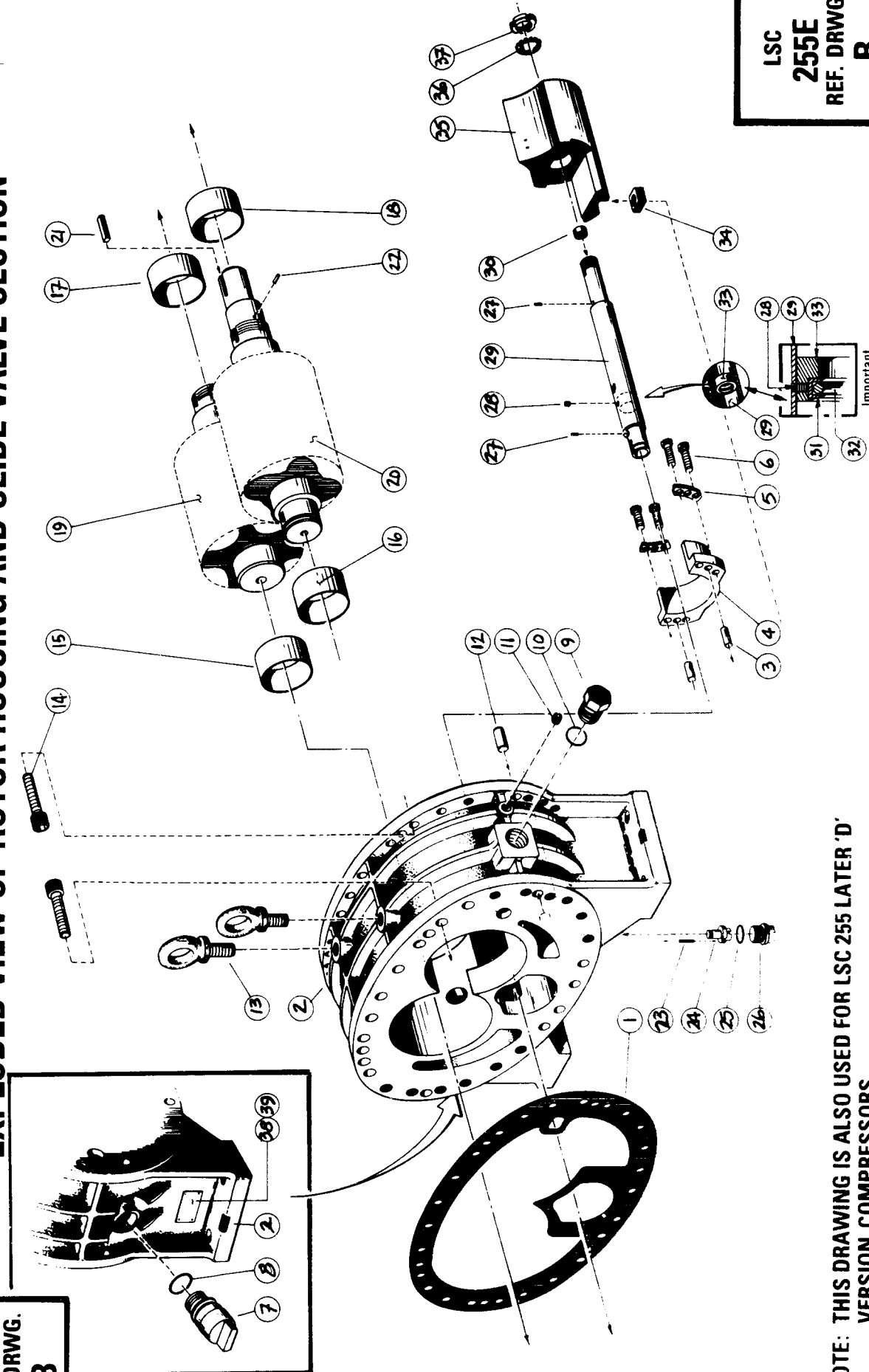

NOTE: THIS DRAWING IS ALSO USED FOR LSC 255 LATER 'D' VERSION COMPRESSORS

LSC 255mm COMPRESSORS – REF. DRAWING 'B' PARTS LISTING FOR MODELS: 2510, 2512, 2515, 2516, 2519 & 2522 'E' & 'F' VERSION MODELS

No.	DESCRIPTION	'E' VERSION PART NO.	'F' VERSION PART NO.
1	Inlet / Rotor Housing Gasket	GKT446	GKT446
2	Rotor Housing Model 2510 : Model 2512 : Model 2515 : Model 2516 : Model 2519 : Model 2522 :	HSG100AT3 HSG140AT3 HSG106AT3 HSG73AT3 055090A1 N/A	055438A1 055440A1 055442A1 055444A1 055885A1 056125A1
3	Slide Valve Guide Pin	(2) PIN51T3	(2) PIN51T3
4	Slide Valve Guide	GDE14	GDE14
5	Slide Valve Guide Locking Plate	PLT1048	PLT1048
6	Slide Valve Guide Hex Head Cap Screws	(4) 012P15	(4) 012P15
7	Vapor Injection Port Plug (V1) 2510 & 2512 "F" Version Vapor Injection 4-Bolt Flange 2515, 2516 & 2519 "F" Version Vapor Inj. 4-Bolt Flange 2522 "F" Version Vapor Injection 4-Bolt Flange	054549A1 N/A 051034A3 (2519) N/A	N/A 051034A4 051034A3 051034A2
8	Vapor Injection Port O-Ring/ Gasket (V1) 2510 & 2512 "F" Version Vapor Injection 4-Bolt Flange 2515, 2516 & 2519 "F" Version Vapor Inj. 4-Bolt Flange 2522 "F" Version Vapor Injection 4-Bolt Flange	RNG292 N/A 054955A1 N/A	N/A 054955A6 054955A1 054955A9
9	Main Oil Port Plug (C4) Main Oil Port 4-Bolt Flange (Qty. of (4) Screws 016P19)	PLU130 051034A3 (2519)	N/A 051034A3
10	Main Oil Port O-Ring (C4) Main Oil Port 4-Bolt Flange Gasket	RNG236 054955A1 (2519)	N/A 054955A1
11	Oil Pressure Plug (C15) (<i>Schraeder Valve on "F" Version</i>)	055P80	VAL929
12	Rotor Housing Dowel Pin	(4) 054905	(4) 051071A9
13	Lifting Eye Bolts	(2) BLT89	(2) BLT89
14	Rotor Housing Socket Head Cap Screw: 2-1/4" Long 2-1/2" Long	(15) 0348P21 (43) 0348P23	(15) 0348P21 (43) 0348P23
15	Inlet End Female Rotor Sleeve	054952A6	054952A6
16	Inlet End Male Rotor Sleeve	054952A5	054952A5
17	Discharge End Female Rotor Sleeve	054952A6	054952A6
18	Discharge End Male Rotor Sleeve	054952A6	054952A6
19 & 20	Rotor Set (Includes Male and Female Rotor) Model 2510 Model 2512 Model 2515 Model 2516 Model 2519 Model 2522	SET69T4 SET70T4 SET71T4 SET72T4 055080A4 N/A	SET69T4 SET70T4 SET71T4 SET72T4 055080A4 055080D7
21	Rotor Shaft Key	KEY9	KEY9
22	Rotor Shaft Spring Pin	PIN80T3	PIN80T3
23	Spindle Pin	PIN53	PIN53

LSC 255mm COMPRESSORS – REF. DRAWING 'B' PARTS LISTING FOR MODELS: 2510, 2512, 2515, 2516, 2519 & 2522 'E' & 'F' VERSION MODELS

No.	DESCRIPTION	'E' VERSION PART NO.	'F' VERSION PART NO.
24	Guide Block Spindle	SPN3	SPN3
25	Spindle Plug O-Ring	GKT238	GKT238
26	Spindle Guide Plug	PLU105	PLU105
27	Spindle Roll Pin	PIN82T3	PIN82T3
28	Spindle Set Screw	051625A1	054093A1
29	Spindle For Model 2510: For Model 2512: For Model 2515: For Model 2516: For Model 2519: For Model 2522:	054873A8 054873A9 054873B1 054873B2 054873B5 054873B6	054873A8 054873A9 054873B1 054873B2 054873B5 054873B6
30	Spindle Plug (Early "E" Versions Only)	054149A1	N/A
31	Spindle Bushing Teflon Cap Seal (Early "E" Versions Only)	054150A1	N/A
32	Spindle Bushing O-Ring (Early "E" Versions Only)	050133E1	N/A
33	Spindle Bronze Bushing (Early "E" Versions Only)	054099A1	N/A
34	Slide Valve Guide Block	GDE10	GDE10
35	Slide Valve: For Model: 2510DHR3V0_0EM0010 2510DLR3V0_0EM0010 2510DUR3V0_0EM0010 2512DHR3V0_0EM0010 2512DLR3V0_0EM0010 2512DUR3V0_0EM0010 2515DHR3V0_0EM0010 2515DLR3V0_0EM0010 2515DUR3V0_0EM0010 2516DHR3V0_0EM0010 2516DLR3V0_0EM0010 2516DUR3V0_0EM0010 2519DHR3V0_0EM0010 2519DLR3V0_0EM0010 2519DUR3V0_0EM0010 2522DHR3V0_0EM0010 2522DLR3V0_0EM0010 2522DUR3V0_0EM0010	VAL743T4 VAL743T3 VAL743T1 VAL744T4 VAL744T3 VAL744T1 VAL745T4 VAL745T3 VAL745T1 VAL746T4 VAL746T3 VAL746T1 055079A1 055079A2 055079A3 N/A N/A N/A	VAL743T4 VAL743T3 VAL743T1 VAL744T4 VAL744T3 VAL744T1 VAL745T4 VAL745T3 VAL745T1 VAL746T4 VAL746T3 VAL746T1 055079A1 055079A2 055079A3 056126A2 056126A3 056126A4
36	Spindle Lockwasher	054251A2	054251A2
37	Spindle Locknut	NUT82	NUT82
38	Compressor Identification Nameplate	053933A1	053933A1
39	Nameplate Round Tap Screws	(4) 065P14	(4) 065P14

LSC
255E
REF. DRWG.
C

LSC 255 'E' & 'F' COMPRESSOR EXPLODED VIEW OF OUTLET PLATE AND BEARING SECTION

NOTE: THIS DRAWING IS ALSO USED FOR LSC 255 LATER 'D'
VERSION COMPRESSORS

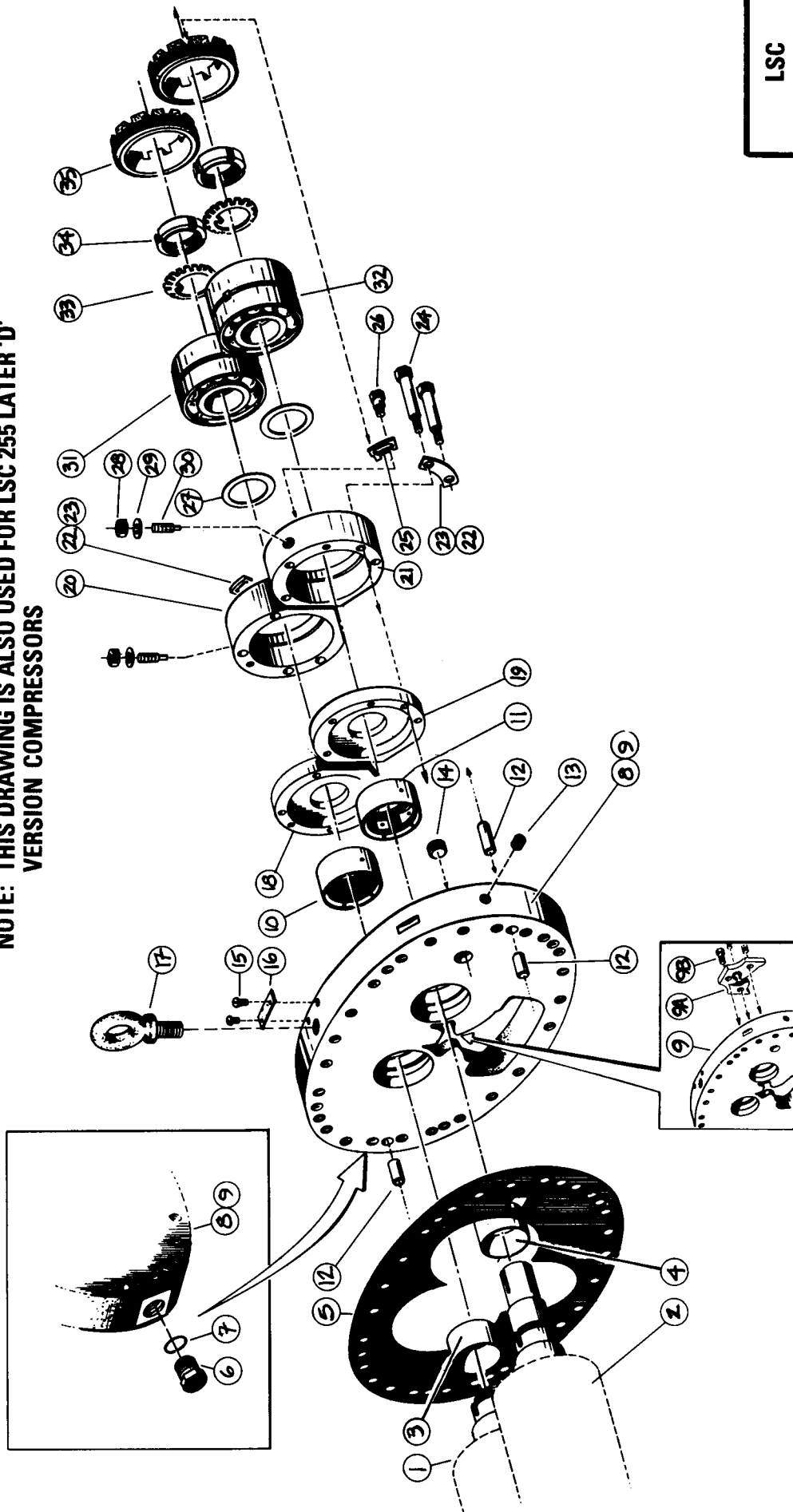

LSC
255E
REF. DRWG.
C

LSC 255mm COMPRESSORS – REF. DRAWING 'C' PARTS LISTING FOR MODELS: 2510, 2512, 2515, 2516, 2519 & 2522 'E' & 'F' VERSION MODELS

No.	DESCRIPTION	'E' VERSION PART NO.	'F' VERSION PART NO.
1 & 2	Rotor Set (Includes Male and Female Rotor) Model 2510 Model 2512 Model 2515 Model 2516 Model 2519 Model 2522	SET69T4 SET70T4 SET71T4 SET72T4 055080A4 055080D7	SET69T4 SET70T4 SET71T4 SET72T4 055080A4 055080D7
3	Discharge End Female Rotor Sleeve	054952A5	054952A5
4	Discharge End Male Rotor Sleeve	054952A6	054952A6
5	Rotor Housing / Outlet End Plate Gasket	GKT447	GKT447
6	Liquid Injection Port Plug (C13)	PLU133	PLU133
7	Liquid Injection Port O-Ring (C13)	RNG239	RNG239
8	Outlet End Plate for : DHR Models Only DLR Models Only DUR Models Only	PLT2017AT2 PLT2017AT2 PLT2153AT2	055626A1 PLT2153AT5 PLT2153AT5
9	Insert Plate For The Outlet Plate (DUR Models Only)	PLT2170T1	PLT2170T1
9B	Insert Plate Screws For Outlet Plate (DUR Models Only)	(3) SCR158	(3) SCR158
10	Female Rotor Discharge Journal Bearing	BRG76	055622A1
11	Male Rotor Discharge Journal Bearing	BRG76	055622A1
12	Outlet End Plate Dowel Pin	054905A1	054905A1
13	Shaft Seal Oil Supply Port (C8)	055P72	055P72
14	Outlet End Plate Plug	PLU142T5	PLU142T5
15	Rotation Indicator Plate Round Tap Screws	065P14	065P14
16	Rotation Indicator Plate	PLT2239	PLT2239
17	Lifting Eye Bolt	(2) BLT89	(2) BLT89
18	Female Rotor Bearing Plate	PLT884	PLT884T2
19	Male Rotor Bearing Plate	PLT883	PLT883T2
20	Female Rotor Bearing Sleeve	SLV32T2	SLV32T2
21	Male Drive Rotor Bearing Sleeve	SLV31T2	SLV31T2
22	Upper Locking Plate	PLT1047	PLT 1047
23	Lower Locking Plate	PLT1047	PLT1047

LSC 255mm COMPRESSORS – REF. DRAWING 'C' PARTS LISTING FOR MODELS: 2510, 2512, 2515, 2516, 2519 & 2522 'E' & 'F' VERSION MODELS

No.	DESCRIPTION	'E' VERSION PART NO.	'F' VERSION PART NO.
24	Bearing Sleeve Hex Head Cap Screw	(2) 014P47	(2) 014P47
25	Locking Plate Locknut	(2) PLT2227	(2) PLT2227
26	Locking Plate Hex Head Cap Screw	(4) 012P07	(4) 012P07
27	Thrust Bearing Shims (2 Places As Required)	SHM21T21-T25	SHM21T21-T25
28	Thrust Bearing Retaining Screw Nut	(2) 012P00	(2) 012P00
29	Thrust Bearing Retaining Screw Lockwasher	(2) 052855A3	(2) 052855A3
30	Thrust Bearing Retaining Screw	(2) SCR176	(2) SCR176
31	Thrust Bearing set Female Rotor	(2) 054996A1	(2) 054996A1
32	Thrust Bearing set Male Rotor	(2) 054996A1	(2) 054996A1
33	Thrust Bearing Lockwasher	(2) WAS67	(2) WAS67
34	Inner Race Thrust Bearing Nut	(2) NUT35	(2) NUT35
35	Outer Race Thrust Bearing Nut	(2) NUT34	(2) NUT34

LSC
255E
REF. DRWG.
D

LSC 255 'E' & 'F' COMPRESSOR EXPLODED VIEW OF DISCHARGE PLATE AND SHAFT SEAL ASSEMBLY SECTION

NOTE: THIS DRAWING IS ALSO USED FOR
LSC 255 LATER 'D' VERSION COMPRESSORS

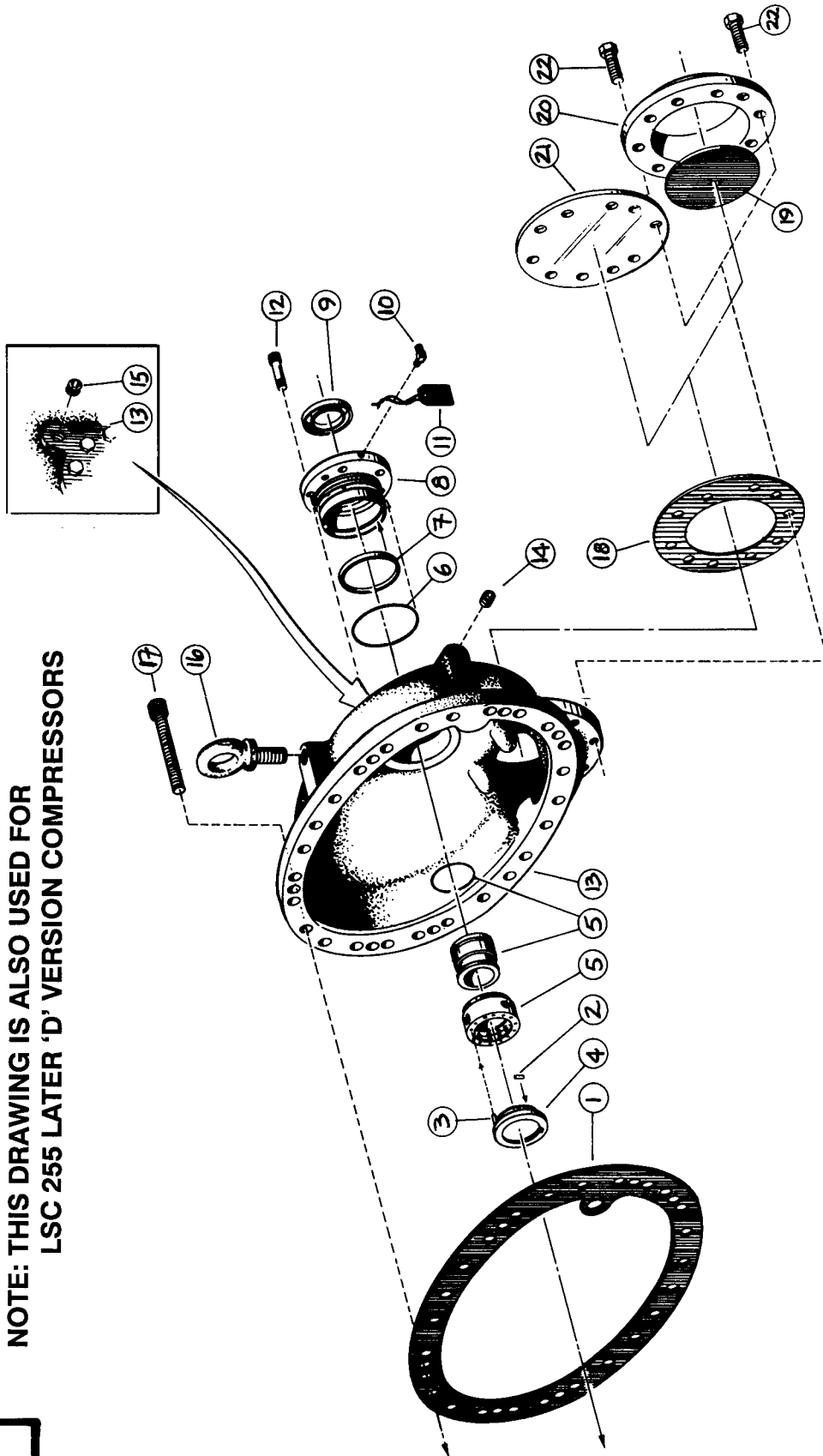

LSC
255E
REF. DRWG.
D

LSC 255mm COMPRESSORS – REF. DRAWING 'D' PARTS LISTING FOR MODELS: 2510, 2512, 2515, 2516, 2519 & 2522 'E' & 'F' VERSION MODELS

No.	DESCRIPTION	'E' VERSION PART NO.	'F' VERSION PART NO.
1	Outlet End Cover Gasket	GKT 448	GKT 448
2	Rotor Shaft Spring Pin	Incl. In Kits	Incl. In Kits
3	Drive Ring Spring Pin	Incl. In Kits	Incl. In Kits
4	Drive Ring	Incl. In Kits	Incl. In Kits
5	Shaft Seal Assembly	SEL63T1 (9B)	055735A2 Bellows
6	Seal Housing O-Ring	Incl. In Kits	Incl. In Kits
7	Inboard Lip Seal	Incl. In Kits	Incl. In Kits
8	Shaft Seal Housing (Incl. In Shaft Seal Conversion Kits)	053642A1	055735A2
9	Outboard Lip Seal	Incl. In Kits	Incl. In Kits
10	Seal Weepage Drain 90° Elbow (C11)	ELL136T1	ELL136T1
2 – 10	Parts shown are included in kits as follows : Replacement Shaft Seal kit for 9B Type Seal W/Lip Seal Conversion Shaft Seal Kit For 9B Type Seal W/ Lip Seal Replacement Shaft Seal kit for Bellows Type Seal Conversion Shaft Seal Kit For Bellows Type Seal	XFRK7T21 XFRK7T19 055738A4 055738A3	N/A N/A 055738A4 055738A3
11	Warranty Tag	053975A1	053975A1
12	Shaft Seal Housing Socket Head Cap Screws	(6) 036P13	(6) 036P13
13	Outlet End Cover	COV98T3	COV98T3
14	Shaft Seal Oil Port Plug (C10)	055P71	055P71
15	Discharge Pressure Port Plug (C14)	055P71	055P71
16	Lifting Eye Bolt	BLT89	BLT89
17	End Cover 2-1/4" Long Socket Head Cap Screws End Cover 2-1/2" Long Socket Head Cap Screws	(5) 0348P21 (24) 0348P23	(5) 0348P21 (24) 0348P23
18	Discharge Flange Gasket	GKT248	GKT248
19	Disc Plate	DIS47	DIS47
20	Discharge Flange Cover	FLG155	FLG155
21	Discharge Disc Cover Discharge Shipping Gasket	DIS54T5 050790B3	DIS54T5 050790B3
22	Discharge Flange Socket Head Cap Screws	(10) 017P13	(10) 017P13