

Pump 62 • Iron • JM Frame • 3500 RPM

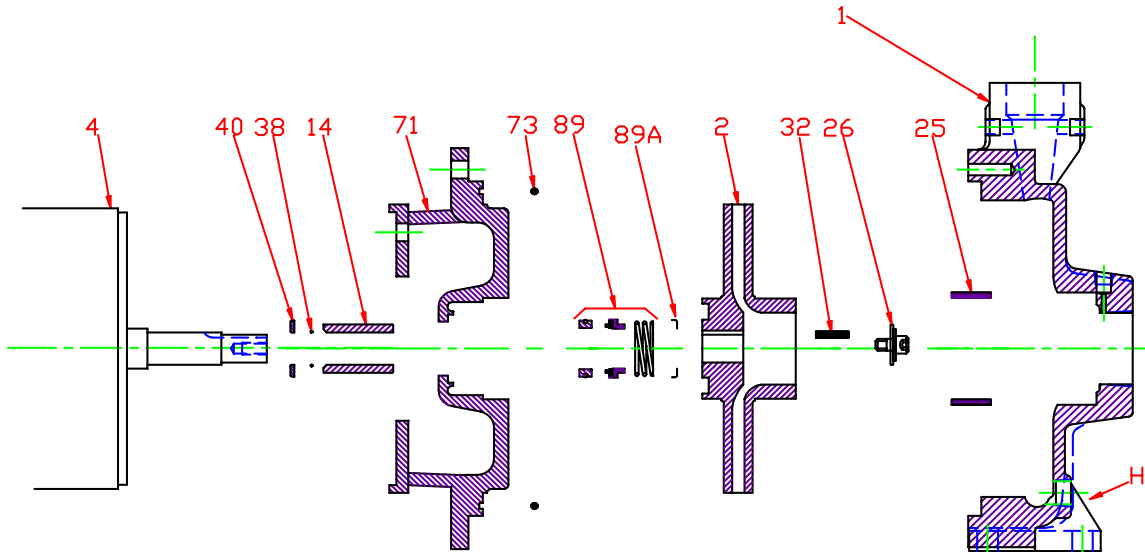

KEY NO.	PART NAME	PUMP NO. 62
1+	CASE, 2 x 1.5 NPT	130.000.260X
2	IMPELLER, 7/8"; KEYED, ENCLOSED, SPECIFY DIAMETER:	
	IRON	137.000.123
	BRONZE	137.002.708
4	MOTOR, JM210	See Chart
	MOTOR, JM210/250	See Chart
14*	SHAFT SLEEVE, BRONZE	110.000.178
	SHAFT SLEEVE, STAINLESS	110.000.192
25	WEAR RING, BRONZE	103.000.166
	WEAR RING, STEEL	103.000.178
26*	IMPELLER RETAINER, STAINLESS	118.000.111A
32*	KEY, STAINLESS	102.000.102
38*	O-RING, SHAFT, BUNA	116.000.117
	O-RING, SHAFT, VITON	116.000.105
40*	FLINGER, STAINLESS	104.000.165
71	ADAPTER, IRON - JM210	132.000.275X
73*	GASKET, CASE, FIBER	116.000.240
89*	1½" SEALS:	
	BN-CARB/CM	101.000.168
	VN-CARB/CM	101.000.191
	VN-CARB/SIL	101.000.175
	VN-SIL/SIL	101.000.204
	EPDM-CARB/SIL	101.000.175B
	EPDM-SIL/SIL	101.000.204A
89A*	SEAL RETAINER, STAINLESS	104.000.174
--	° REPAIR KITS:	
	BN-CARB/CM SEAL	118.000.386
	VN-CARB/CM SEAL (S)	118.000.386A
	VN-CARB/SIL SEAL	118.000.386B
	VN-SIL/SIL SEAL (S)	118.000.386E
	EPDM-CARB/SIL SEAL	118.000.386C
	EPDM-SIL/SIL SEAL	118.000.386F

* DENOTES COMPONENTS INCLUDED IN REPAIR KIT.
 + INCLUDES BRONZE WEAR RING. FOR STEEL WEAR RING, REPLACE SUFFIX "X" WITH "X1".
 ° ALL REPAIR KITS INCLUDE THE BRONZE SHAFT SLEEVE EXCEPT THE (S) INDICATED, WHICH IS STAINLESS WITH VITON SHAFT O-RING.

Pump 62 • Iron • JM Frame • 3500 RPM

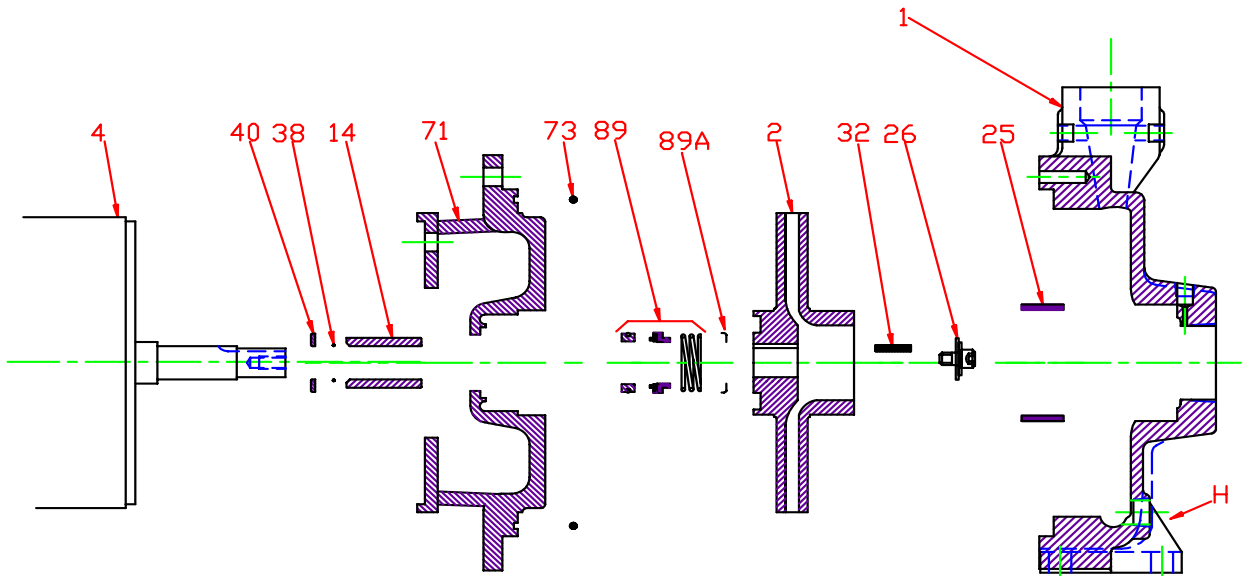

CONSTRUCTION OPTIONS

KEY	PART NAME	STANDARD FITTED	ALL IRON
1	Case	Iron	Iron
2	Impeller	Bronze	Iron
14	Shaft Sleeve	Bronze	Stainless
25	Wear Ring	Bronze	Steel
26	Imp. Retaining Ass'y	Stainless	Stainless
32	Key	Stainless	Stainless
38	Shaft O-Ring	BUNA	BUNA
40	Flinger	Stainless	Stainless
71	Adapter	Iron	Iron
73	Gasket, Case	BUNA	BUNA
89	Mechanical Seal, Type 21 BN-CM	Standard	Standard
H	Plug, Drain	Brass	Plated Steel

E062JM

A15

C0623500JM