

MOTOR DIMENSIONS

NEMA PREMIUM EFFICIENT JP FRAME 3 PHASE 3500 RPM

HP	Type	Frame	D	E	F	O	AB	BG	L	MH
30	ODP	JP284	6.97	5.50	4.75	13.07	11.37	9.53	11.53	0.53
40	ODP	JP286	6.97	5.50	5.50	13.07	11.37	10.28	10.78	0.53
50	ODP	JP324	8.00	6.25	5.25	15.59	13.20	10.53	10.90	0.66
60	ODP	JP326	8.00	6.25	6.00	14.63	12.21	11.29	11.15	0.66
75	ODP	TCZ364*	9.00	7.00	5.63	16.52	13.20	11.54	10.52	0.66
100	ODP	TCZ365*	9.00	7.00	6.12	16.59	13.20	12.04	12.02	0.66
30, 40	TEFC	JP286	7.00	5.50	5.50	14.11	11.07	10.02	13.04	0.53
50, 60	TEFC	JP326	8.00	6.25	6.00	15.93	12.58	11.00	14.60	0.66
75	TEFC	TCZ364*	9.00	7.00	5.63	18.38	15.00	11.54	13.87	0.66
100	TEFC	TCZ405*	10.00	8.00	6.88	21.1	19.36	13.5	17.7	0.81

D063JPS324

DRAWING DEPICTS JPS324 50HP ODP MOTOR

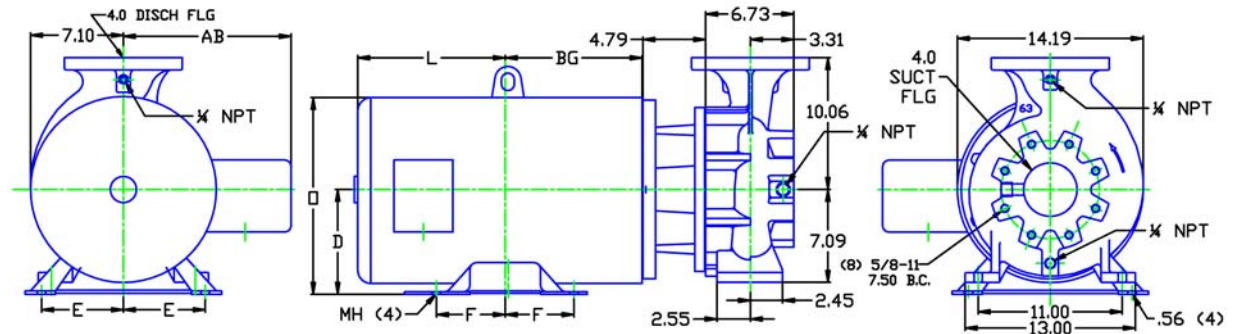

ALL DIMENSIONS IN INCHES.

DRAWING REPRESENTS APPROXIMATE PUMP DIMENSIONS. AUTOCAD DRAWING TO SCALE AVAILABLE FROM FACTORY.

* 326JP Shaft

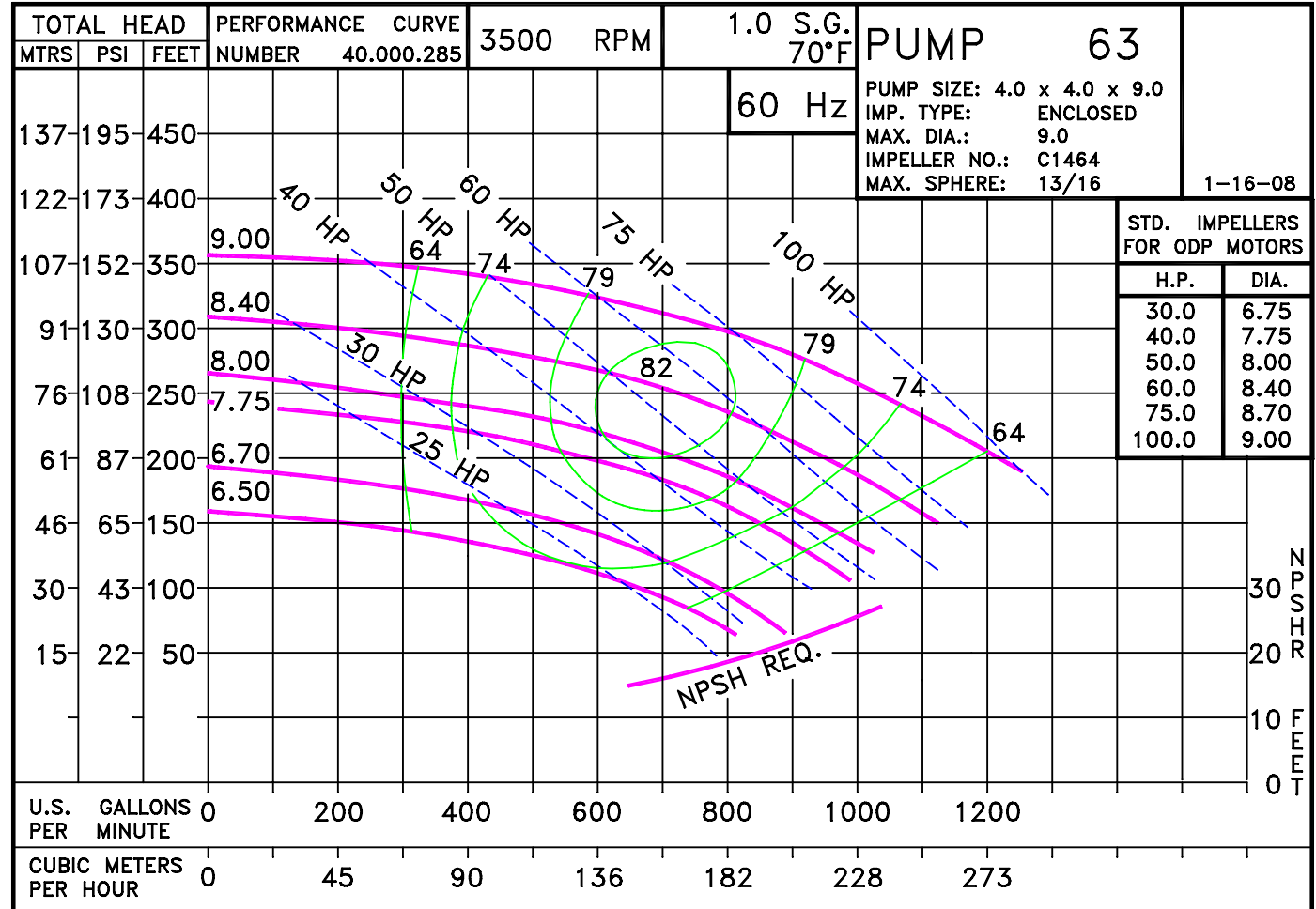
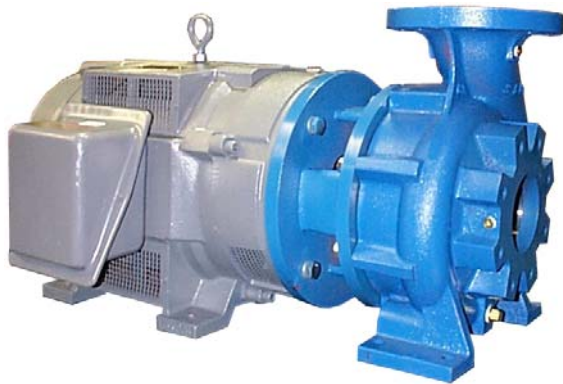

06350DP

D063JPS324
0633500

63 JP

0633500JP
81.000.919 M16

Pump 63 • Iron • JP Frame • 3500 RPM

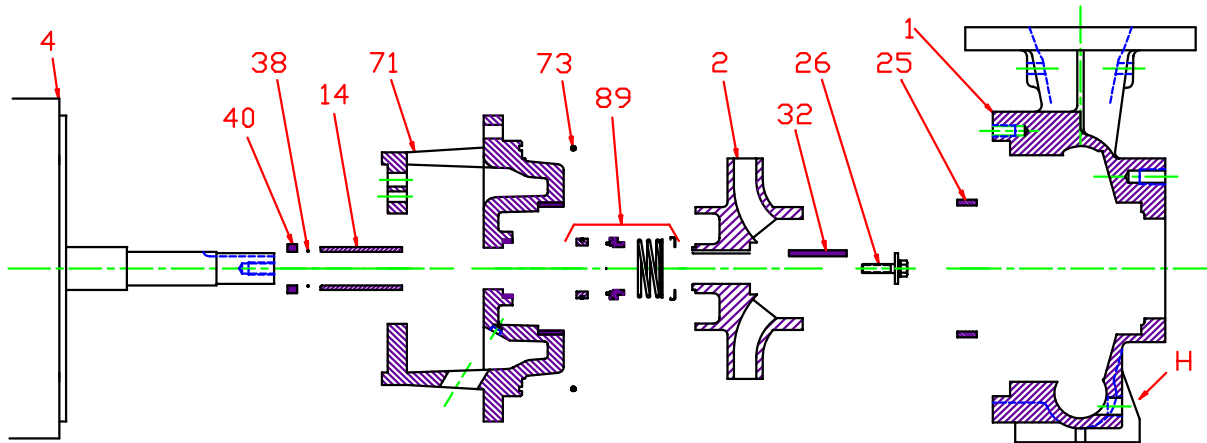

KEY NO.	PART NAME	PUMP NO. 63
1+	CASE, IRON, 4x4 FLG	130.000.256X
2	IMPELLER, 1¼" KEYED, ENCLOSED, SPECIFY DIAMETER: IRON BRONZE	137.000.146 137.000.145
4	MOTOR, JP280/320 MOTOR, JP360	See Chart See Chart
14*	SHAFT SLEEVE, BRONZE SHAFT SLEEVE, STAINLESS	110.000.397 110.000.308
25	WEAR RING, BRONZE WEAR RING, STAINLESS	110.000.301 110.000.300
26*	IMPELLER RETAINER, STAINLESS	118.000.640
32*	KEY, STAINLESS	102.000.257
38*	O-RING, SHAFT	116.000.241
40*	FLINGER, STAINLESS	110.000.307
71	ADAPTER, IRON, JP280/320/360	132.000.271
73*	GASKET, CASE, BUNA	116.000.240
89*	1¼" SEALS:	
	BN-CARB/CM	101.000.196
	VN-CARB/CM	101.000.216
	VN-CARB/SIL	101.000.221
	VN-SIL/SIL	101.000.231
	EPDM-CARB/SIL	101.000.196B
	EPDM-SIL/SIL	137.001.555
--	° REPAIR KITS:	
	BN-CARB/CM SEAL	118.000.388
	VN-CARB/CM SEAL (S)	118.000.388A
	VN-CARB/SIL SEAL	118.000.388B
	VN-SIL/SIL SEAL (S)	118.000.388C
	EPDM-CARB/SIL SEAL	118.000.388D
	EPDM-SIL/SIL SEAL	118.000.388E

* DENOTES COMPONENTS INCLUDED IN REPAIR KIT.
 + INCLUDES BRONZE WEAR RING. FOR STEEL WEAR RING, REPLACE SUFFIX "X" WITH "X1".
 ° THE REPAIR KIT INCLUDES THE BRONZE SHAFT SLEEVE EXCEPT THE (S) INDICATED, WHICH IS STAINLESS.

Pump 63 • Iron • JP Frame • 3500 RPM

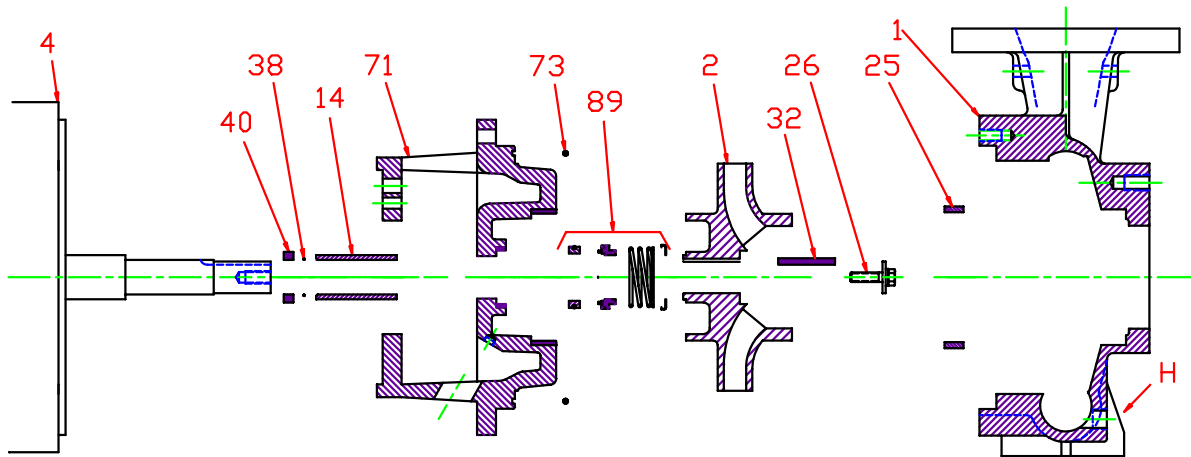

CONSTRUCTION OPTIONS

KEY	PART NAME	STANDARD FITTED	BRONZE FITTED	ALL IRON
1	Case	Iron	Iron	Iron
2	Impeller	Iron	Bronze	Iron
14	Shaft Sleeve	Bronze	Bronze	Stainless
25	Wear Ring, Case	Bronze	Bronze	Steel
26	Impeller Retainer	Stainless	Stainless	Stainless
32	Key	Stainless	Stainless	Stainless
38	Shaft O-Ring	BUNA	BUNA	BUNA
40	Flinger	Stainless	Stainless	Stainless
71	Adapter	Iron	Iron	Iron
73	Gasket, Case	BUNA	BUNA	BUNA
89	Mechanical Seal, Type 21 BN-CM	Standard	Standard	Standard
H	Plug, Drain	Brass	Brass	Plated Steel

E063JP210

C11

C0633500JP